

RoHS, ELV適合品

RoHS, ELV COMPLIANT

Note1. The soldering process is allowed up to twice under the same condition. However, the interval between the first and second process must be maintained at the room temperature.

1. リフロー回数: 2回, 但し, 2回目のリフローにおいては, 一度, 室温に戻すこと.

Note2. The temperature indicates the board surface temperature on the connector lead area.

2. リフロー温度の測定は, コネクタリード部の基板表面温度を測定のこと.

Note3. Hand soldering: 280~300°C, 2s max.

3. 手半田温度: 280~300°C, 2S以内

Note4. Coplanarity: 0.1 max.

4. 端子平坦度: 0.1以下

Note5. Recommended thickness of PCB: 1.6mm.

5. 推奨基板厚: 1.6mm

RECOMMENDED REFLOW PROFILE

IR reflow condition	IR リフロー条件
Preheating area 150°C for 60 to 120 seconds	予備加熱: 60~120秒, 150°C
Peak temperature: 250°C	ピーク温度: 250°C
Soldering area 235±5°C or 10 seconds max.	リフロー温度: 230~240°C, 10秒以内
△: 230°C min. for 20-40 seconds	230°C以上: △: 20~40秒

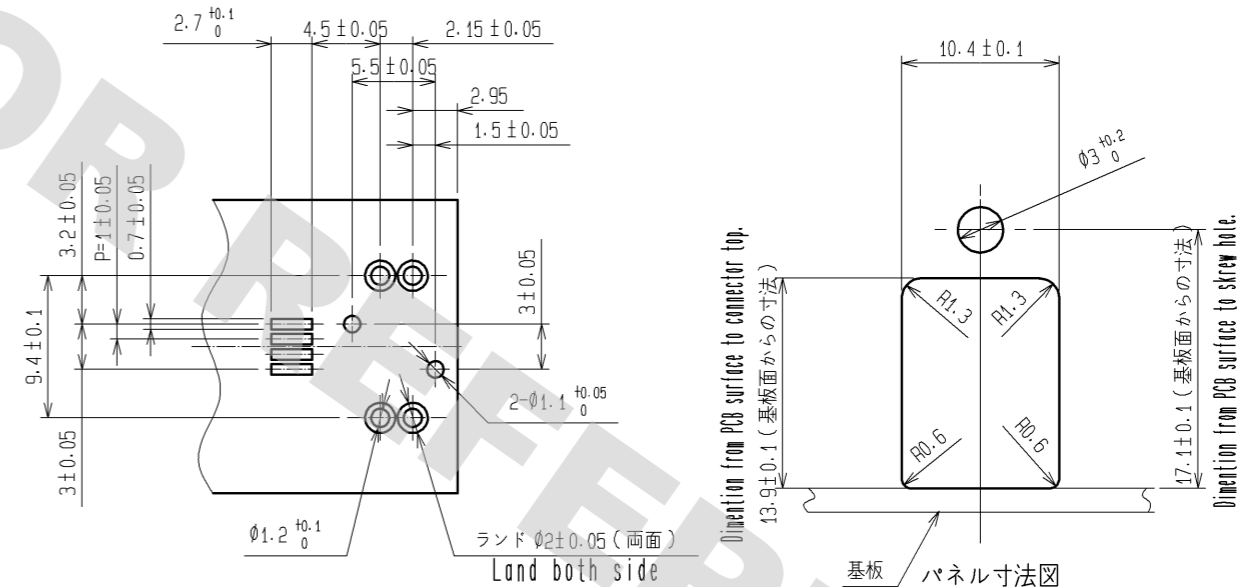
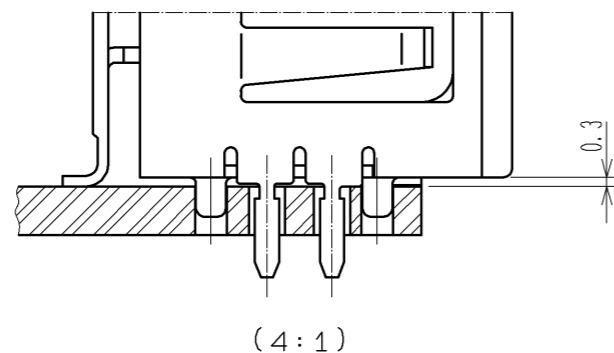
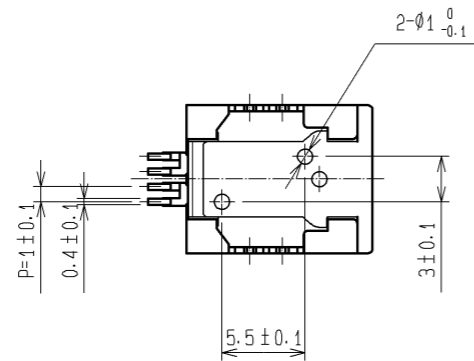
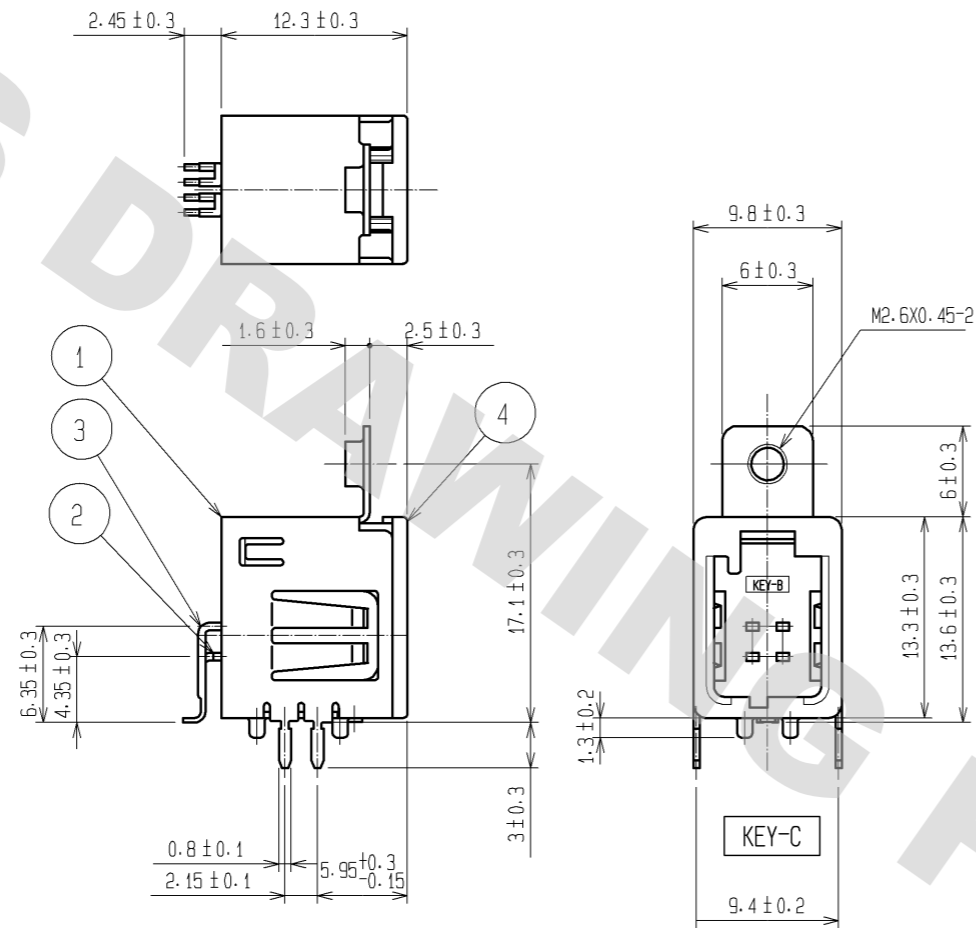
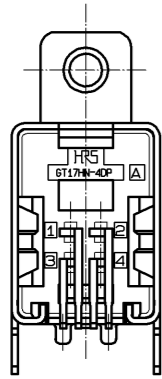
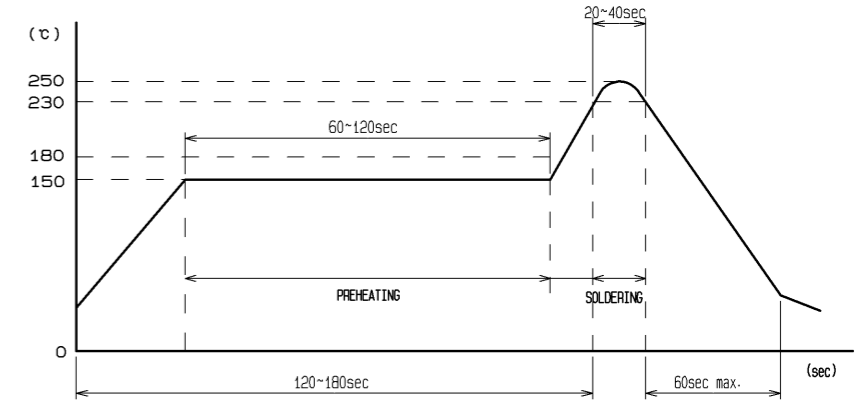

基板推奨寸法図
Recommended PCB layout

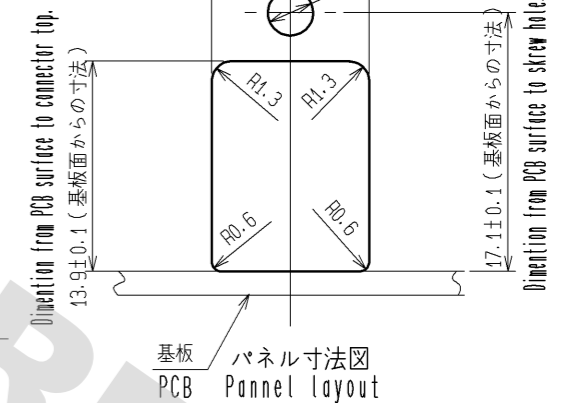

基板
PCB
パネル寸法図
Panel layout

2	BRASS	TIN PLATING	5	PS	TRAY NATURAL
1	COPPER ALLOY	TIN PLATING	4	PPS	GREEN
			3	BRASS	TIN PLATING
NO.	MATERIAL	FINISH . REMARKS	NO.	MATERIAL	FINISH . REMARKS
UNITS mm		SCALE 2 : 1	COUNT 2	DESCRIPTION OF REVISIONS DIS-T-002095	
APPROVED : AR. SHIRAI			10.01.14	DESIGNED MH. SHOUJI	CHECKED NH. NAKATA
CHECKED : AR. SHIRAI			10.01.14	DATE 11.01.24	
DESIGNED : NH. NAKATA			10.01.14	DRAWING NO. EDC3-167010-05	
DRAWN : NH. NAKATA			10.01.14	PART NO. GT17HN-4DP-2H(CB)	
HRS HIROSE ELECTRIC CO., LTD.				CODE NO. CL767-0175-0-00	

DRAWING FOR REFERENCE: This is subject to change without notice
08/11/2012

DRAWING FOR REFERENCE: This is subject to change without notice
08/11/2012

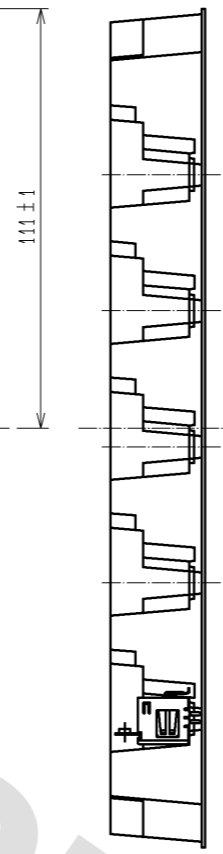
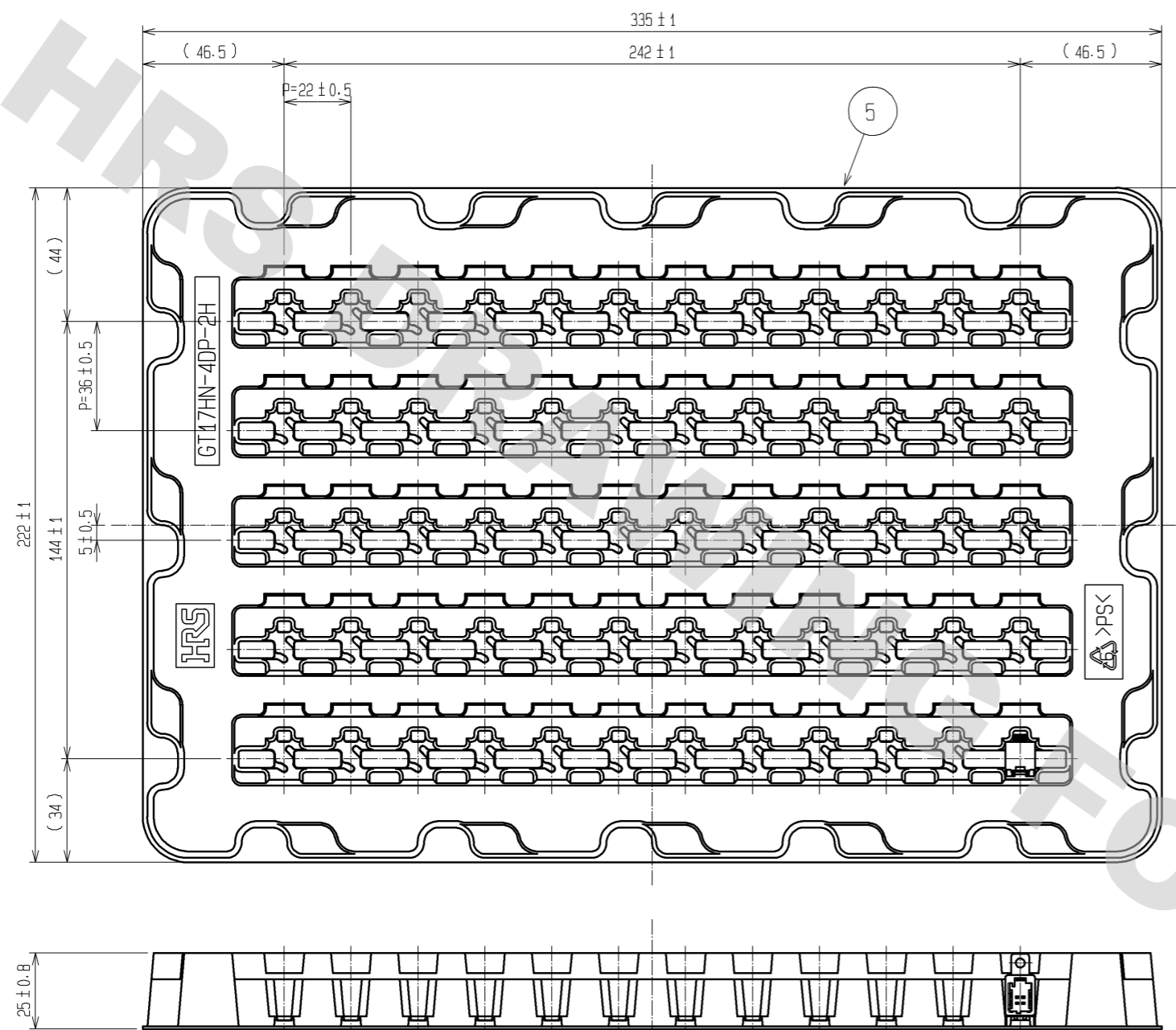

梱包仕様
W=270・D=360・H=150のサイズのダンボール箱に下図のように製品を入れる。

PACKAGING STYLE
BOX SIZE : W=270・D=360・H=150

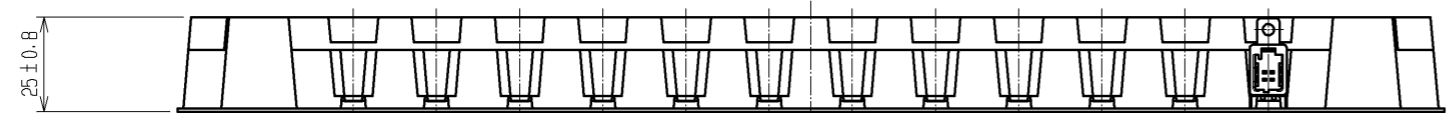
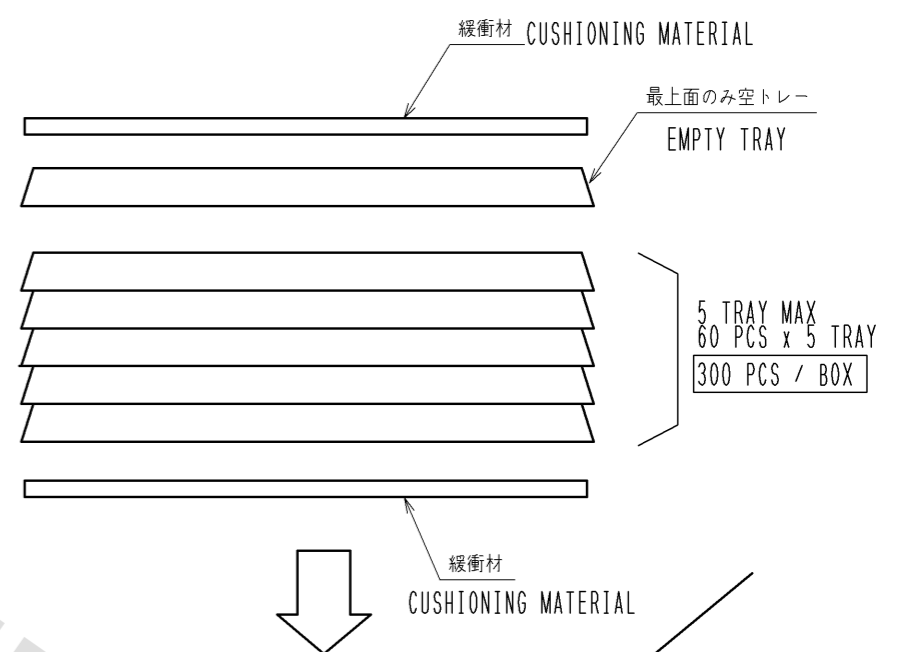

60 PCS / TRAY

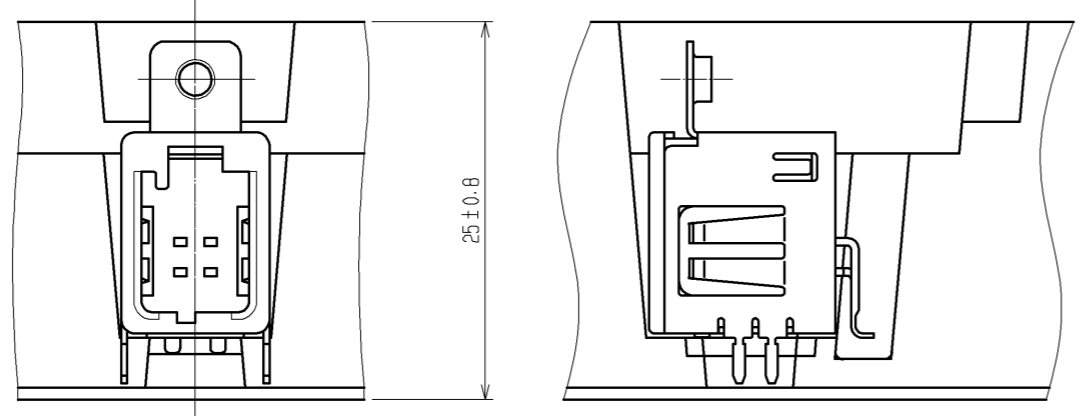

製品格納状態図(2:1)
PACKAGING CONDITION (2:1)

納入先	
品名	
数量	個

HRS	DRAWING NO.	EDC3-167010-05
	PART NO.	GT17HN-4DP-2H(B)
	CODE NO.	CL767-0175-0-00
		2/2

Mouser Electronics

Authorized Distributor

Click to View Pricing, Inventory, Delivery & Lifecycle Information:

[Hirose Electric:](#)

[GT17HN-4DP-2H\(B\)](#)