

2 In case of consideration for using Automotive equipment / device which demand high reliability, kindly contact our sales window correspondents.

7

8

COUNT	DESCRIPTION OF REVISIONS	BY	CHKD	DATE	COUNT	DESCRIPTION OF REVISIONS	BY	CHKD	DATE
△					△				
△					△				
△					△				

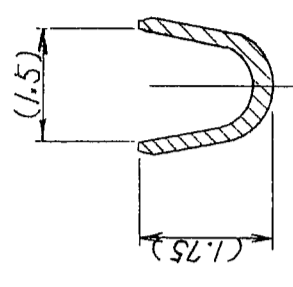

B-B

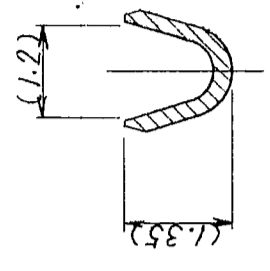

A-A

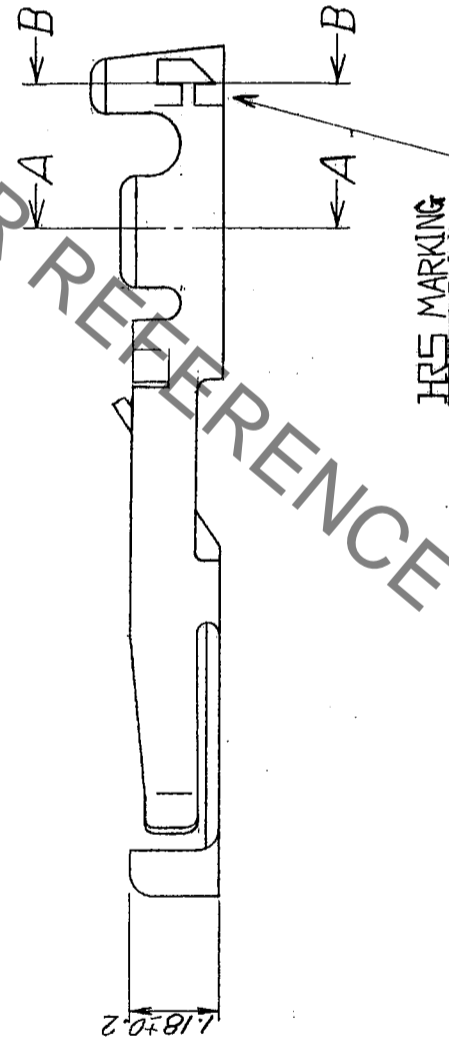
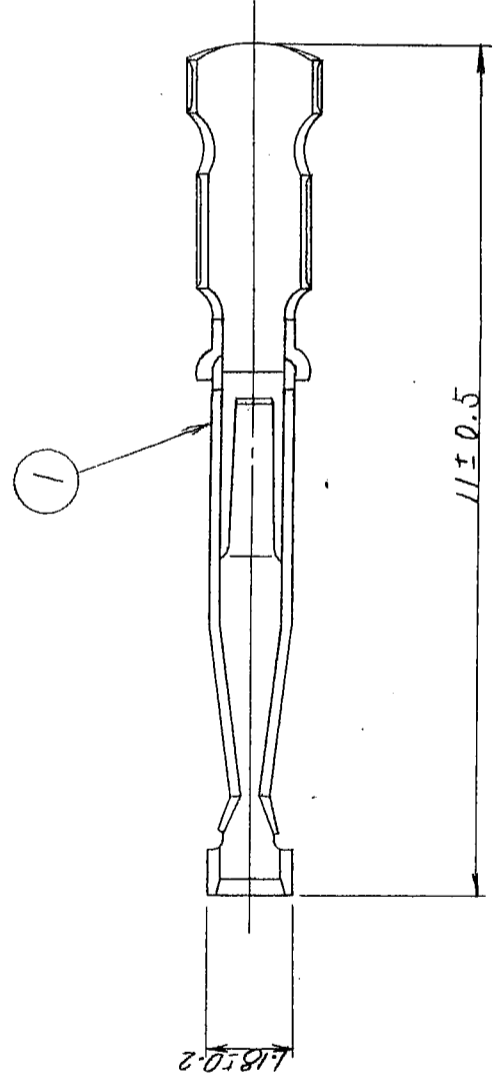

HRS DRAWING FOR REFERENCE

NOTE 1 THIS CONTACT IS APPLICABLE WIRE:AWG#24 TO 30
INSULATOR OUTER DIA.OF φ 1.15 OR LESS
2 APPLICABLE MANUAL CONTACT CRIMPING TOOL:
RP19-TC-12(CL150-0049-4)

1	PHOSPHOR BRONZE	SILVER PLATING 2μm min. (100pcs/bag)							
NO.	MATERIAL	FINISH, REMARKS							
CODE NO. (OLD)	CL								
			DRAWN	DESIGNED	CHECKED	APPROVED	RELEASED		
			<i>T. Kawanishi</i>	<i>D. Motomura</i>	<i>E. Kuni</i>	<i>M. Saito</i>			
			05.10.13	05.10.13	05.10.13	05.10.13			
			DRAWING NO.		PART NO.				
			EDC3-021921		RP19-SC-122				
			SCALE		CODE NO.				
			10 : 1		CL113-0270-0				
			UNITS		HRS				
			mm		HIROSE ELECTRIC CO., LTD				

TO
R

Mouser Electronics

Authorized Distributor

Click to View Pricing, Inventory, Delivery & Lifecycle Information:

[Hirose Electric:](#)

[RP19-SC-122](#)