

Sep.1.2021 Copyright 2021 HIROSE ELECTRIC CO., LTD. All Rights Reserved.  
In case of consideration for using Automotive equipment / device which demand high reliability, kindly contact our sales window correspondents.

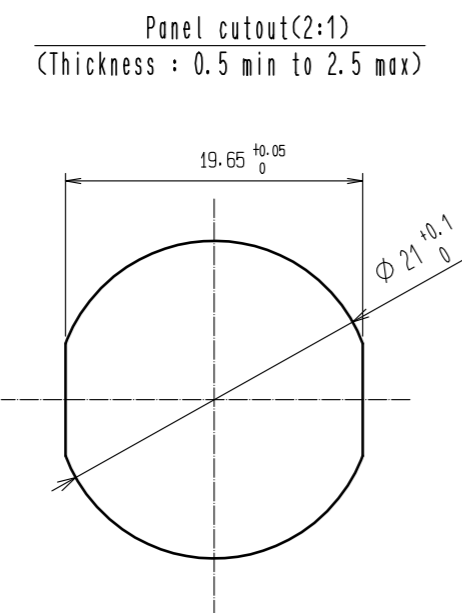
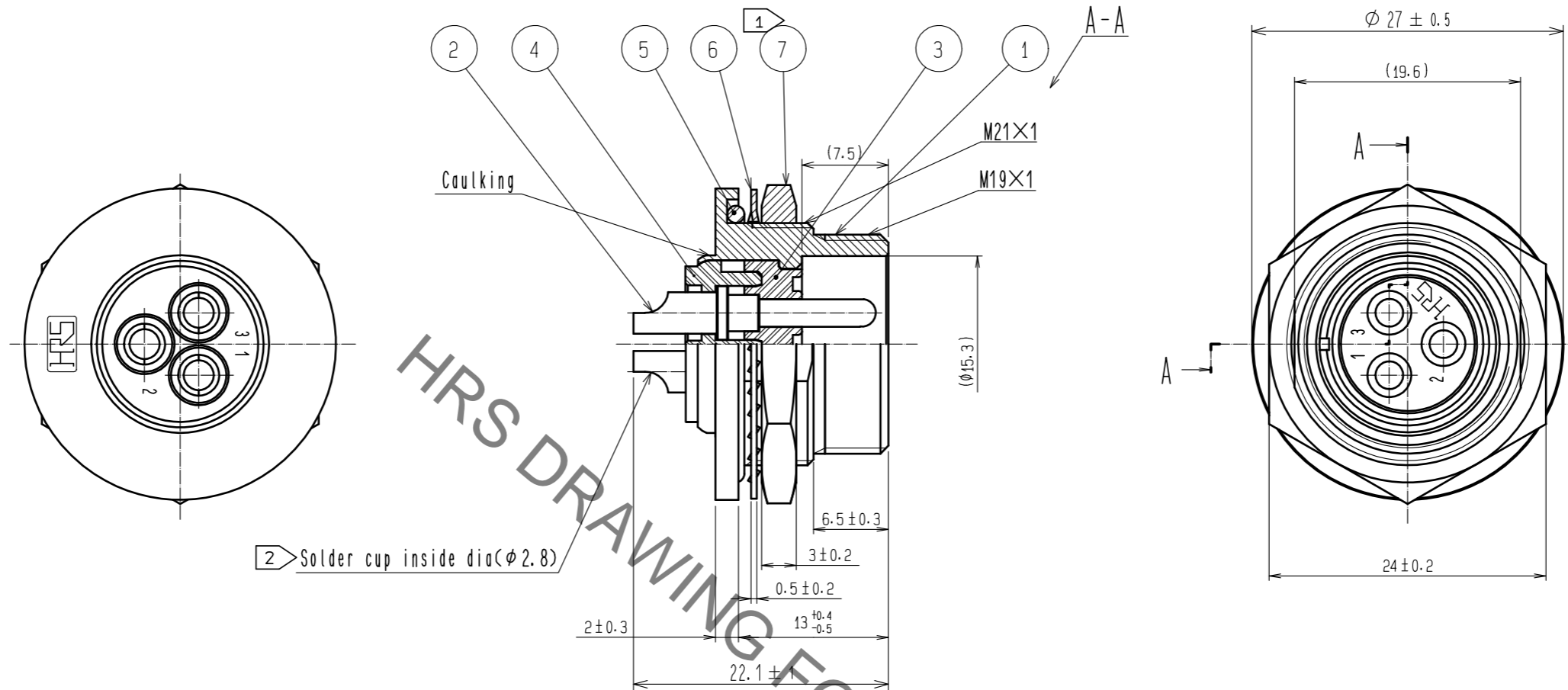

- Notes
- ① The recommended clamp torque of ref. No. ⑦ to be 3 N·m.  
LOCTITE 243, HENKEL JAPAN or equivalent is recommended to prevent ref. No. ⑦ from loosening.
  - ② The direction of solder cup is an example.
  - ③ Plating  
Surface : Gold 0.2μm min.  
Under plating : Nickel 3μm min.

NO.	MATERIAL	FINISH . REMARKS	NO.	MATERIAL	FINISH . REMARKS
4	Diallyl phthalate	(Black) UL94V-0	7	Brass	Nickel plating
3	Diallyl phthalate	(Black) UL94V-0	6	Phosphor bronze	Nickel plating
2	Brass	③	5	Silicone rubber	(Black)
1	Zinc alloy	Chrome plating			

UNITS	SCALE	COUNT	DESCRIPTION OF REVISIONS	DESIGNED	CHECKED	DATE
mm	2 : 1	2	DIS-C-00007456	TY. SUZUKI	HY. KOBAYASHI	20210806

APPROVED	CHECKED	DESIGNED	DRAWN	DRAWING NO.	PART NO.	CODE NO.
MO. SATOH	EJ. KUNII	DS. MATSUNE	MM. ISHII	EDC3-111084-72	RM15WTRZA-3P(72)	CL0109-1652-2-72
20061026	20061026	20061026	20061025			

# Mouser Electronics

Authorized Distributor

Click to View Pricing, Inventory, Delivery & Lifecycle Information:

[Hirose Electric:](#)

[RM15WTRZA-3P\(72\)](#)