

Aug.1.2021 Copyright 2021 HIROSE ELECTRIC CO., LTD. All Rights Reserved.
In case of consideration for using Automotive equipment / device which demand high reliability, kindly contact our sales window correspondents.

RoHS, ELV COMPLIANT

NOTES

- 1) CONTACT COPLANARITY: 0.1mm MAX.
- 2) RECOMMENDED THICKNESS OF SOLDERING PASTE: 0.15mm
- 3) RECOMMENDED REFLOW PROFILE (SEE RIGHT GRAPH)
TYPE:IR REFLOW
ATMOSPHERE: FAR INFRARED RAY, AIR OR N₂
CYCLE TIME: UP TO 2 CYCLES OF REFLOW SOLDERING ARE POSSIBLE UNDER THE CONDITIONS, PROVIDED THAT THERE IS A RETURN TO NORMAL TEMPERATURE BETWEEN THE FIRST AND SECOND CYCLE.
PEAK TEMPERATURE: 250°C
230°C MIN. FOR 20 TO 40 SECONDS.
PREHEATING AREA 150°C FOR 60 TO 120 SECONDS.
- 4) HAND SOLDERING: 280-300°C, 2S MAX.
- 5) RECOMMENDED THICKNESS OF PCB: 1.6mm

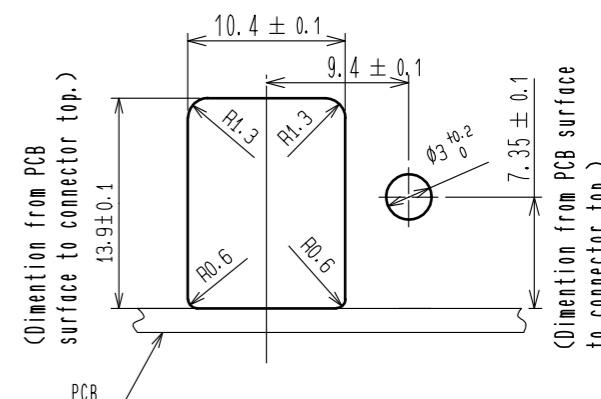
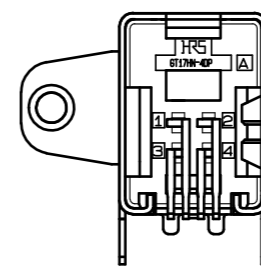
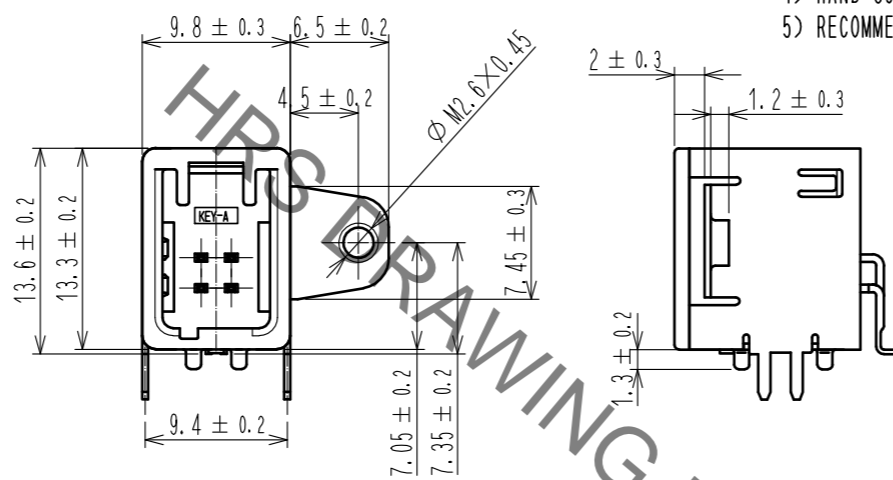
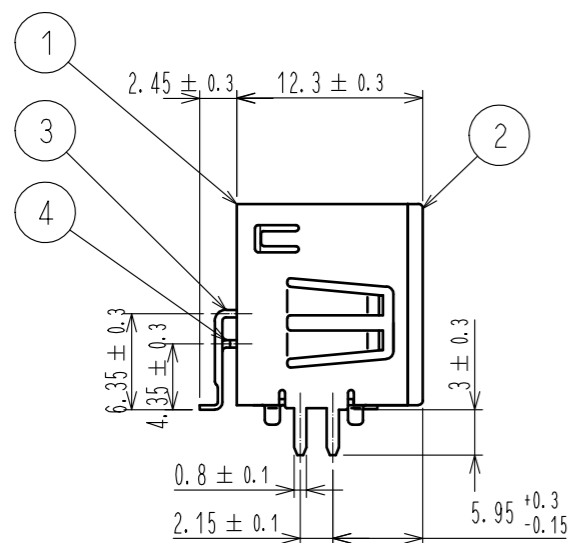
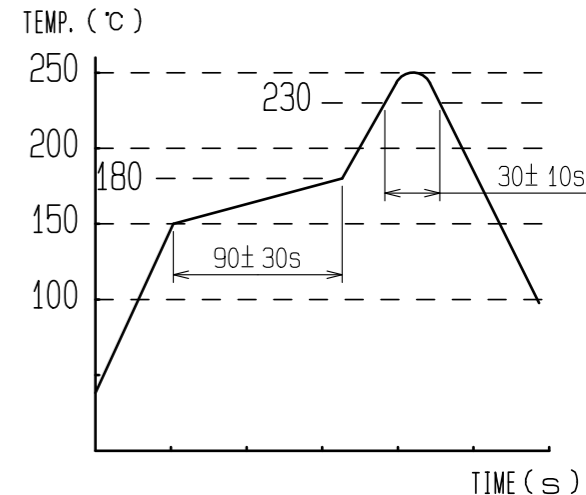

RECOMMENDED PANNEL LAYOUT

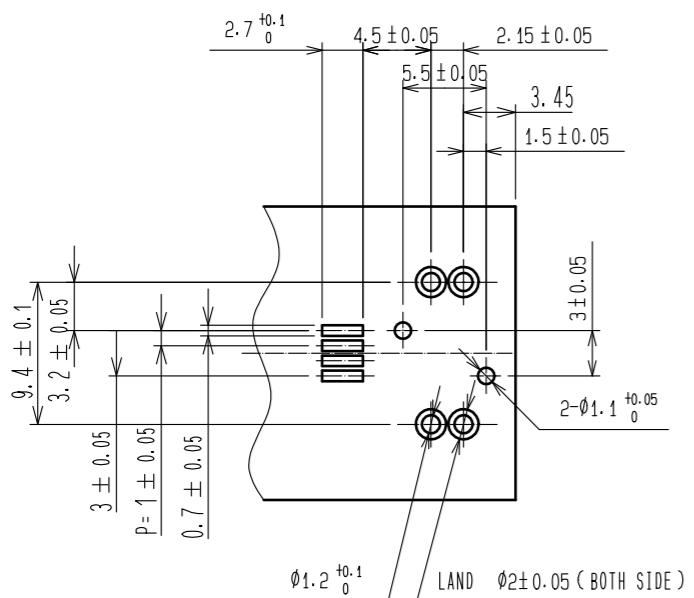

RECOMMENDED PCB LAYOUT

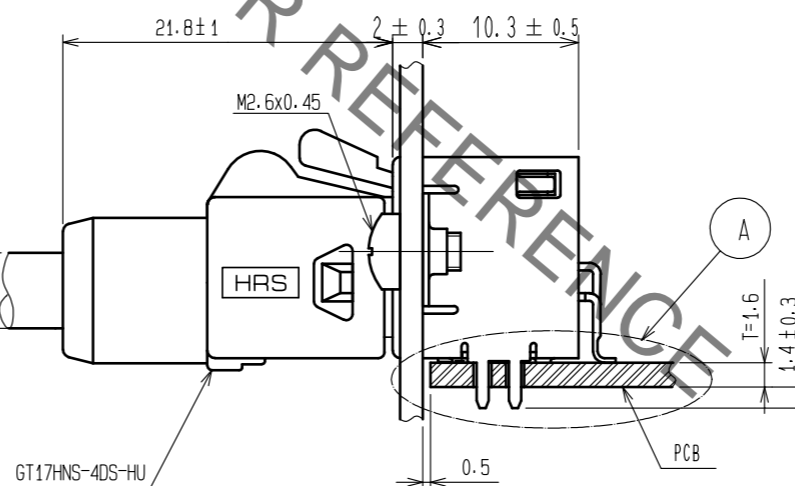
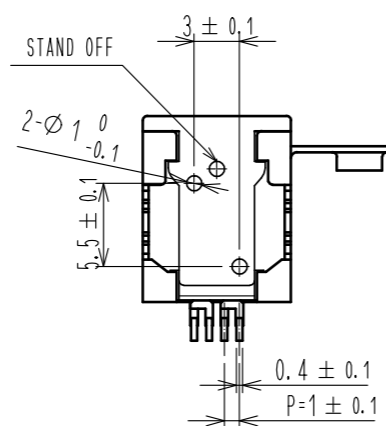

IN COMBINATION WITH STRAIGHT CONNECTOR

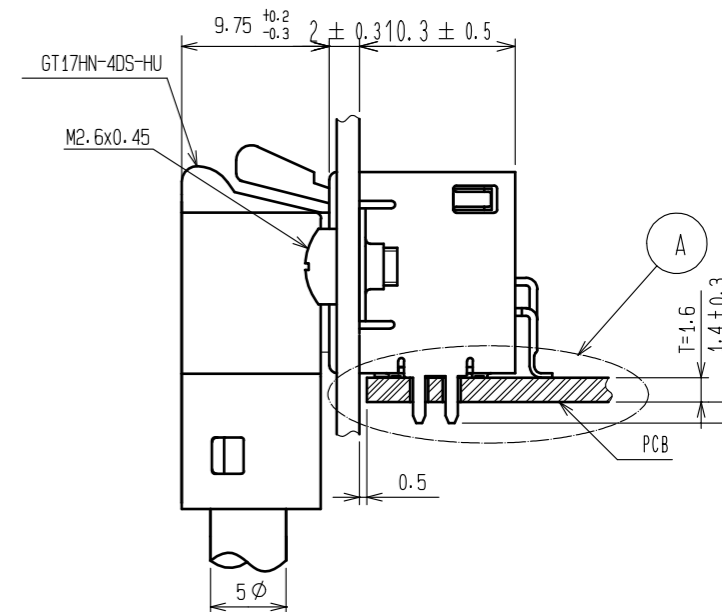

IN COMBINATION WITH RIGHT-ANGLE CONNECTOR

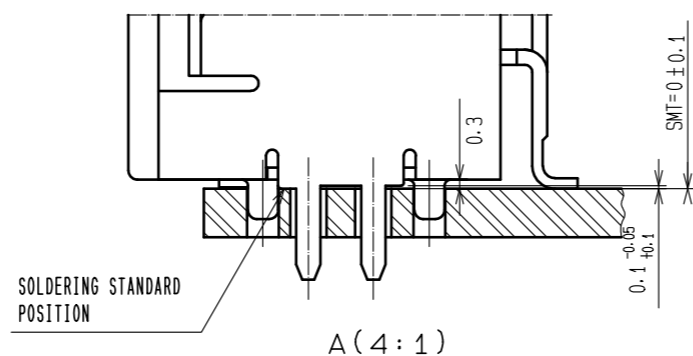

SOLDERING STANDARD POSITION

2	PPS	BROWN	4	BRASS	TIN PLATING
1	COPPER ALLOY	TIN PLATING	3	BRASS	TIN PLATING
NO.	MATERIAL	FINISH . REMARKS	NO.	MATERIAL	FINISH . REMARKS
UNITS mm	⊙	SCALE 2 : 1	COUNT	DESCRIPTION OF REVISIONS	DESIGNED
APPROVED : KI. HIROKAWA		20200331	DRAWING NO. EDC-167690-55-00		
CHECKED : E.J. WAKATSUKI		20200330	PART NO. GT17HNR-4DP-2H(A)(55)		
DESIGNED : TS. KUBOTA		20200325	CODE NO. CL767-0230-6-55		
DRAWN : YK. MITSUISHI		20200317	DATE		

Mouser Electronics

Authorized Distributor

Click to View Pricing, Inventory, Delivery & Lifecycle Information:

[Hirose Electric:](#)

[GT17HNR-4DP-2H\(A\)\(55\)](#)