

Sep.1.2021 Copyright 2021 HIROSE ELECTRIC CO., LTD. All Rights Reserved.  
In case of consideration for using Automotive equipment / device which demand high reliability, kindly contact our sales window correspondents.

ELV-RoHS COMPLIANT

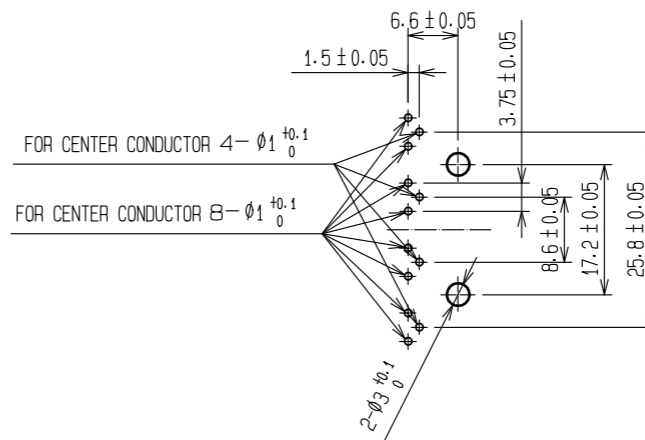

RECOMMENDED PC BOARD HOLE PATTERN

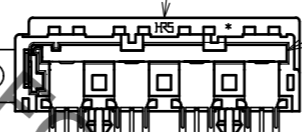
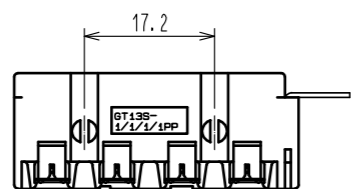
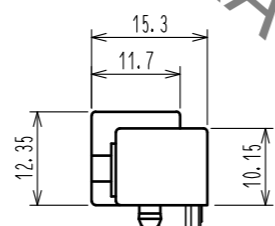
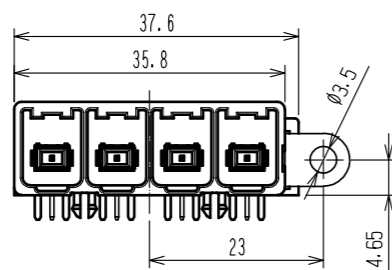
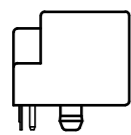
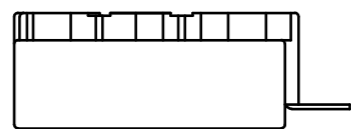
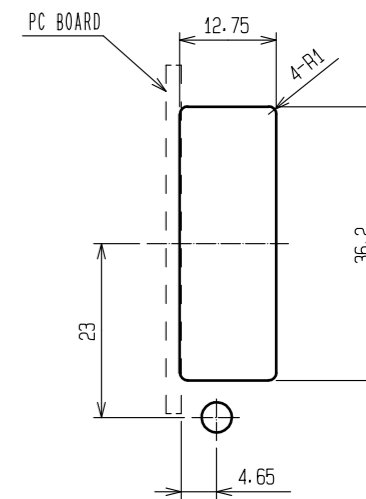

RECOMMENDED PANEL CUT OUT

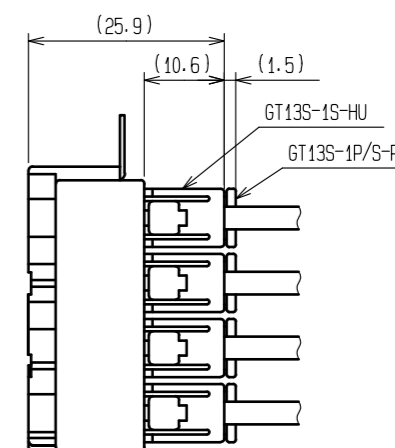

MATED CONNECTOR

HRS DRAWING FOR REFERENCE

2	Cu ALLOY	TIN PLATED	5	Cu ALLOY	TIN PLATED
1	Cu ALLOY	TIN PLATED	4	Cu ALLOY	TIN PLATED
			3	PBT	UL94HB, LIGHT GRAY
NO.	MATERIAL	FINISH . REMARKS	NO.	MATERIAL	FINISH . REMARKS
UNITS		SCALE	COUNT	DESCRIPTION OF REVISIONS	
mm		1 : 1		DESIGNED	CHECKED
HIROSE ELECTRIC CO., LTD.			APPROVED : NH. NAKATA	15. 09. 03	DRAWING NO.
			CHECKED : KI. HIROKAWA	15. 09. 03	PART NO.
			DESIGNED : MH. YAMAGUCHI	15. 08. 19	CODE NO.
			DRAWN : MH. YAMAGUCHI	15. 08. 19	
				EDC-166870-00-00	
				GT13S-1/1/1/1PP-DS	
				CL763-0117-8-00	
				1/1	

# Mouser Electronics

Authorized Distributor

Click to View Pricing, Inventory, Delivery & Lifecycle Information:

[Hirose Electric:](#)

[GT13S-1/1/1/1PP-DS](#)