

Customer Information Sheet

IF IN DOUBT - ASK



NOT TO SCALE

THIRD ANGLE PROJECTION

ALL DIMENSIONS IN mm

SPECIFICATIONS:

MATERIAL:
 HOUSING = GLASS-FILLED PPS,
 UL94V-0, BLACK
 CONTACT = COPPER ALLOY
 JACKSCREW = STAINLESS STEEL

FINISH:
 CONTACT = GOLD

PACKING:
 LOOSE
 FOR COMPLETE SPECIFICATION, SEE COMPONENT
 SPECIFICATION C005XX (LATEST ISSUE)

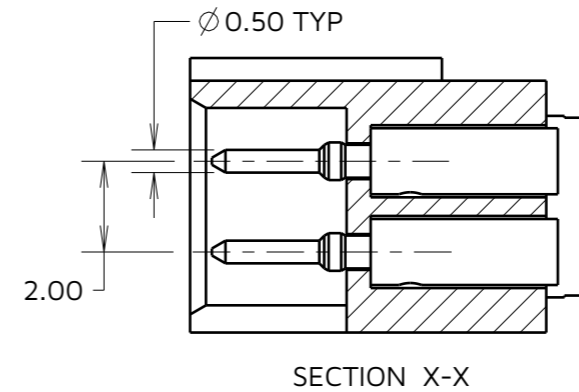
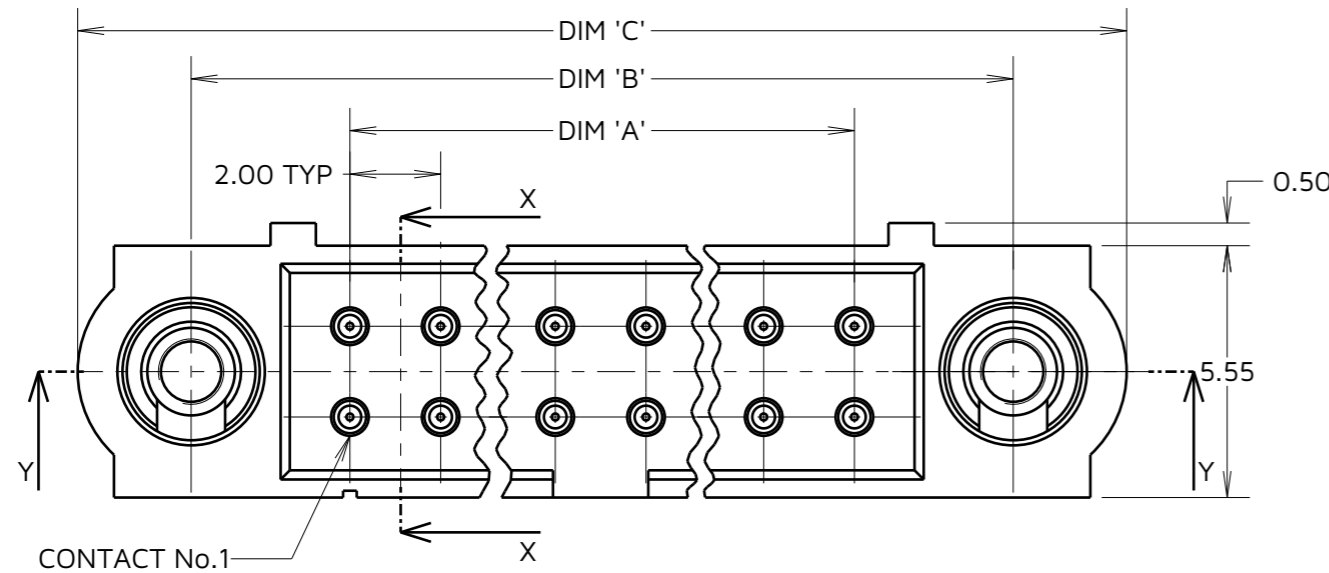
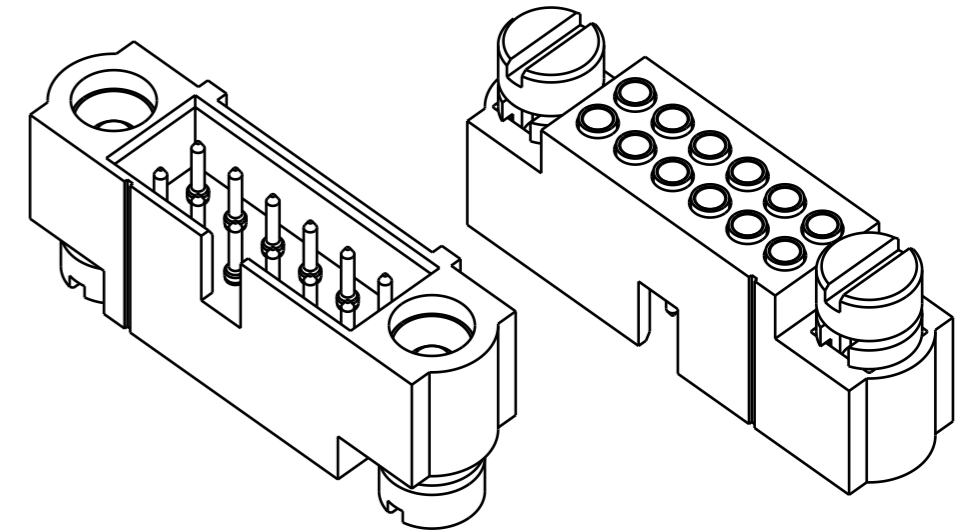
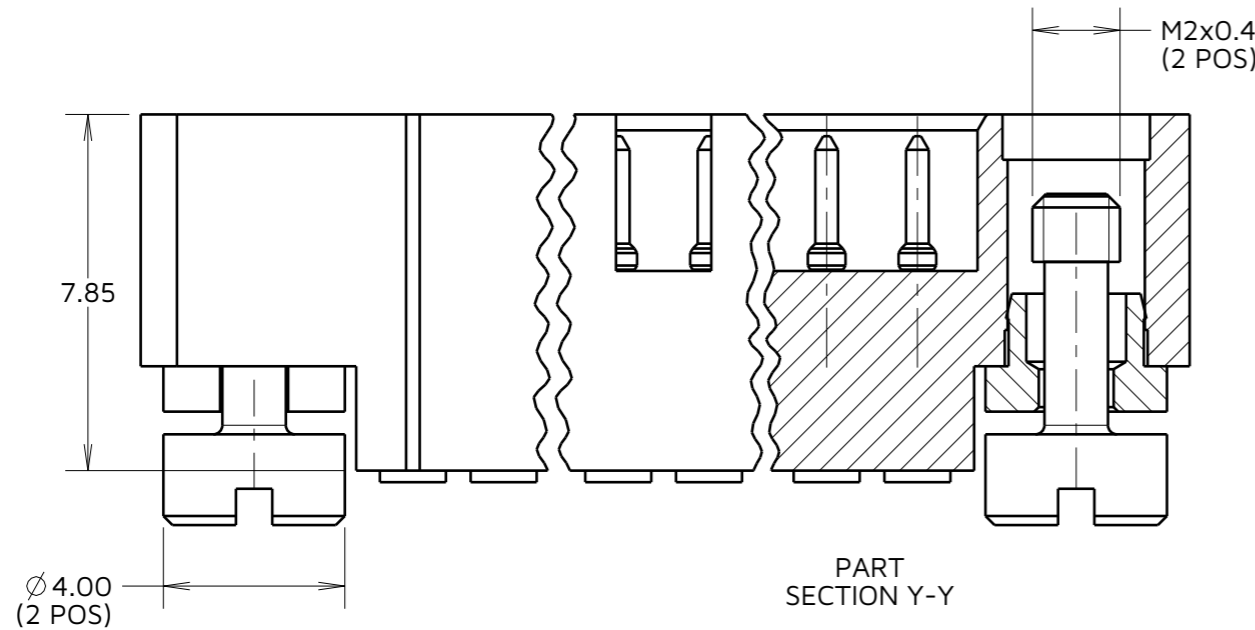

TABLE 1: DIMENSION VARIANTS

PART No.	DIM 'A'	DIM 'B'	DIM 'C'
M80-5620405	18.00	19.50	20.5
M80-5620605	18.00	19.50	20.5
M80-5620805	6.00	7.50	8.5
M80-5621005	18.00	19.50	20.5
M80-5621205	18.00	19.50	20.5
M80-5621405	12.00	13.50	14.5
M80-5621605	14.00	15.50	16.5
M80-5621805	16.00	17.50	18.5
M80-5622005	18.00	19.50	20.5
M80-5622205	20.00	21.50	22.5
M80-5622405	22.00	23.50	24.5
M80-5622605	24.00	25.50	26.5
M80-5622805	26.00	27.50	28.5
M80-5623005	28.00	29.50	30.5
M80-5623205	30.00	31.50	32.5
M80-5623405	32.00	33.50	34.5
M80-5623605	34.00	35.50	36.5
M80-5623805	36.00	37.50	38.5
M80-5624005	38.00	39.50	40.5
M80-5624205	40.00	41.50	42.5
M80-5624405	42.00	43.50	44.5
M80-5624605	44.00	45.50	46.5
M80-5624805	46.00	47.50	48.5
M80-5625005	48.00	49.50	50.5



ORDER CODE:
M80-562XX05
 TOTAL No. OF CONTACTS
 04 TO 50
 (EVEN NUMBERS ONLY)

NOTES:

- CONNECTORS ARE SUPPLIED WITH CONTACTS LOOSE.
- FOR EXTRA CONTACTS, USE PART NUMBER M80-1940005.
- RECOMMENDED WIRE TYPE = BS 3G 210 TYPE A, PTFE INSULATED 22 AWG. MAX INSULATION DIAMETER = ϕ 1.10mm, STRIP WIRE BY 2.00mm.
- RECOMMENDED HAND CRIMP TOOL = M22520/2-01 WITH POSITIONER Z80-193. REFER TO TOOLING INSTRUCTION SHEET IS-01 FOR COMPLETE CRIMPING INSTRUCTIONS.
- CONTACT INSERTION AND EXTRACTION TOOL = Z80-280. REFER TO TOOLING INSTRUCTION SHEET IS-25 FOR ASSEMBLY INSTRUCTIONS.
- PART M80-5621205 USED FOR ILLUSTRATION ONLY.

HARWIN

www.harwin.com

TOLERANCES
 X. = \pm 1mm
 X.X = \pm 0.50mm
 X.XX = \pm 0.20mm
 X.XXX = \pm 0.01mm
 ANGLES = \pm 5°
 UNLESS STATED

THIS DRAWING AND ANY INFORMATION OR DESCRIPTIVE MATTER SET OUT HEREON ARE CONFIDENTIAL AND COPYRIGHT PROPERTY OF THE HARWIN GROUP AND MUST NOT BE DISCLOSED, LOANED, COPIED OR USED FOR MANUFACTURING, TENDERING OR FOR ANY OTHER PURPOSE WITHOUT THEIR WRITTEN PERMISSION.

MATERIAL:
 SEE ABOVE

TITLE: DATAMATE J-TEK
 MALE DIL LARGE BORE CRIMP
 WITH 'REVERSE FIX' JACKSCREW

DRAWING NUMBER:
M80-562XX05

SHT
 2 OF 2

JD	4	10.09.24	34310
NAME	ISS.	DATE	CN/CO
APPROVED:		J.DEAN	
CHECKED:		A.YEOMANS	
DRAWN:		B. M. KENT	

Mouser Electronics

Authorized Distributor

Click to View Pricing, Inventory, Delivery & Lifecycle Information:

[Harwin:](#)

[M80-5620605](#) [M80-5621005](#) [M80-5621205](#) [M80-5621405](#) [M80-5621805](#) [M80-5622005](#) [M80-5622605](#) [M80-5623405](#) [M80-5624205](#) [M80-5625005](#) [M80-5621605](#) [M80-5620405](#) [M80-5620805](#)