

2x04~2x08

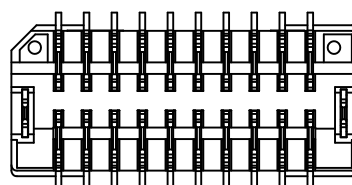

2x04~2x08

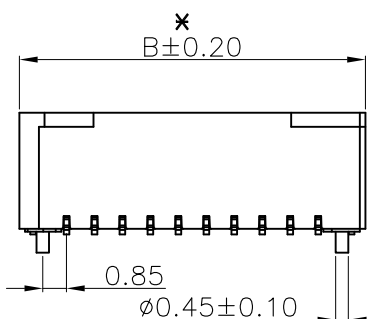
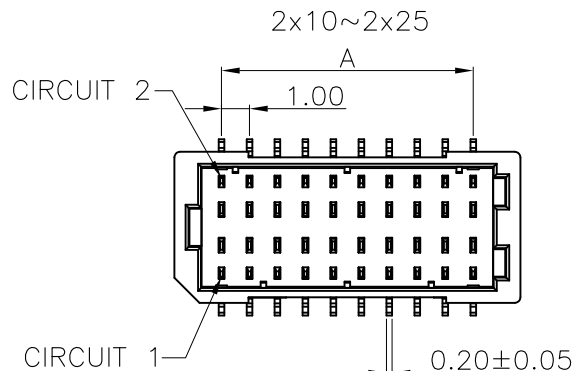
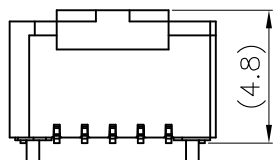
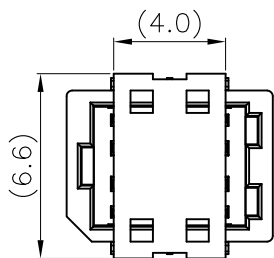
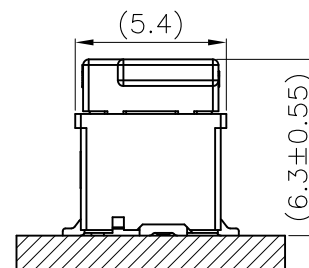
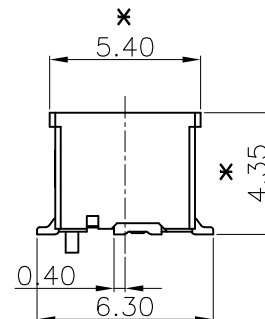
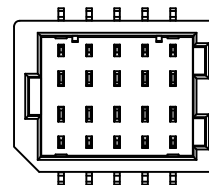

Mating Condition (REF.)

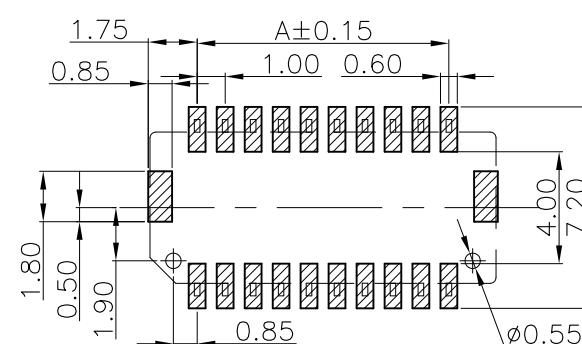

TOLERANCE: ±0.05
RECOMMENDED P.C.B. Layout
TOP VIEW

| Pin | Dim.(mm) | | Order Code |
|------|----------|-------|-------------|
| | A | B | |
| 2X05 | 4.00 | 7.30 | M40-3020546 |
| 2X06 | 5.00 | 8.30 | M40-3020646 |
| 2X07 | 6.00 | 9.30 | M40-3020746 |
| 2X08 | 7.00 | 10.30 | M40-3020846 |
| 2X10 | 9.00 | 12.30 | M40-3021046 |
| 2X12 | 11.00 | 14.30 | M40-3021246 |
| 2X15 | 14.00 | 17.30 | M40-3021546 |
| 2X20 | 19.00 | 22.30 | M40-3022046 |
| 2X25 | 24.00 | 27.30 | M40-3022546 |

| | | | |
|-------|---|----------|------|
| Leo | 9 | 22.05.19 | A541 |
| Leo | 8 | 08.02.18 | A532 |
| Allan | 7 | 28.07.09 | A225 |
| Allan | 6 | 06.10.08 | A166 |
| Allan | 5 | 25.06.08 | A136 |
| Allan | 4 | 25.06.08 | A132 |
| Allan | 3 | 19.06.08 | A130 |
| Allan | 2 | 29.06.07 | A056 |
| Allan | 1 | 01.08.06 | -- |

| NAME | ISS. | DATE | C/NOTE |
|------|------|------|--------|
|------|------|------|--------|

APPROVED: B.Lim

CHECKED: D.P

DRAWN: Leo

CUSTOMER REF.:

ASSEMBLY DRG:

SPECIFICATIONS:
MATERIAL:
 INSULATION: LCP, UL94V-0 (HALOGEN FREE); COLOR: CREAM
 CONTACT: COPPER ALLOY, t=0.20mm
FINISH:
 MATTE-TIN PLATED OVER NICKEL
ELECTRICAL:
 CURRENT RATING: 1A AC/DC
 WORKING VOLTAGE: 50V AC/DC
 WITHSTANDING VOLTAGE: 500V AC/MINUTE
 CONTACT RESISTANCE: 20 mΩ MAX.
 INSULATION RESISTANCE: 100 MΩ MIN.
ENVIRONMENTAL:
 TEMPERATURE RANGE: -25°C TO +85°C

OBSELETE:
 Loose
 (without R)

NOTE:
 ALL DIMENSIONS AND NOTES MARKED * ARE CRITICAL AND
 MUST BE CHECKED IN ACCORDANCE WITH QUALITY DOC. QI-02A

~~NOTE: REMOVE R FOR LOOSE BAG PACKING~~
 ORDER CODE
 M40-302 XX 46R
 NO. OF WAYS WITH R: REEL PACKING
~~WITHOUT R: LOOSE BAG PACKING
 (10 PCS PER STRIP, 10 STRIPS PER BAG)~~

HARWIN

HARWIN USA
 TEL: 603 893 5376
 FAX: 603 893 5396
 mis@harwin.com

HARWIN Europe (UK)
 TEL: 023 9231 4545
 FAX: 023 9231 4590
 mis@harwin.co.uk

HARWIN Asia
 TEL: +65 6 779 4909
 FAX: +65 6 779 3868
 mis@harwin.com.sg

THIS DRAWING AND ANY
 INFORMATION OR DESCRIPTIVE
 MATTER SET OUT HEREON ARE
 CONFIDENTIAL AND COPYRIGHT
 PROPERTY OF THE HARWIN
 GROUP AND MUST NOT BE
 DISCLOSED, LOANED, COPIED
 OR USED FOR MANUFACTURING,
 TENDERING OR FOR ANY
 OTHER PURPOSE WITHOUT
 THEIR WRITTEN PERMISSION.

TOLERANCES
 X. = ±1mm
 X.X = ±0.25mm
 X.XX = ±0.15mm
 X.XXX = ±0.08mm
 ANGLES = ±5°
 UNLESS STATED

MATERIAL:
 SEE NOTES
FINISH:
 SEE NOTES
S/AREA: mm²

TITLE:
 WAFER 1.00mm DIL SMT TYPE

DRAWING NUMBER:
 M40-302 XX 46 X

SHT
 1
 OF
 2

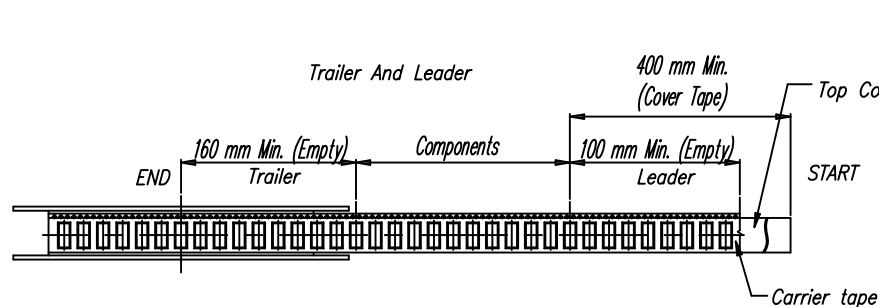

PEEL OFF DIRECTION

PEELING ANGLE
165°~180°

PULL OUT DIRECTION

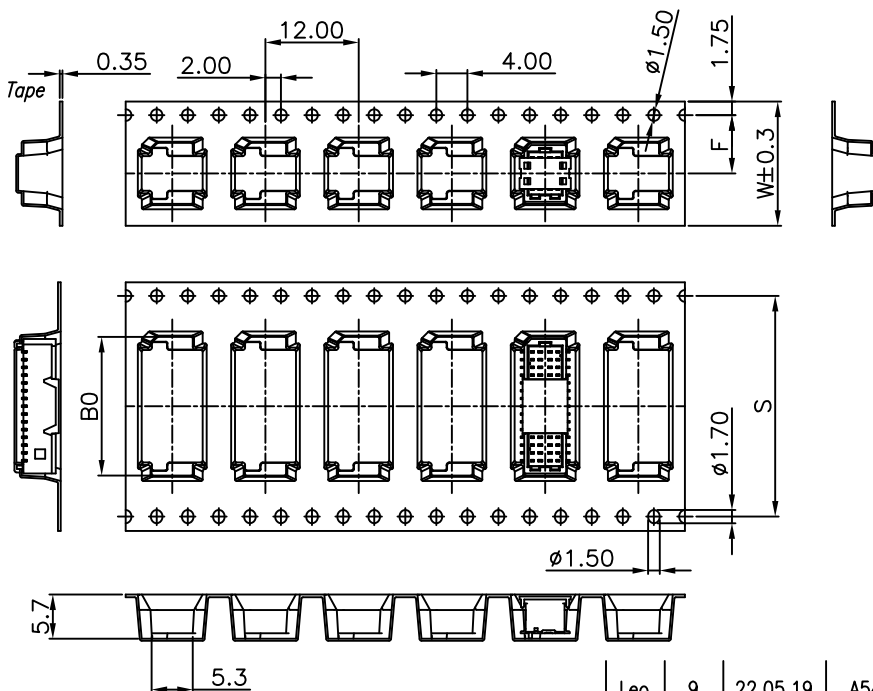
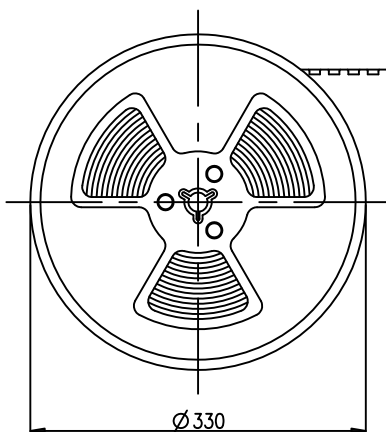
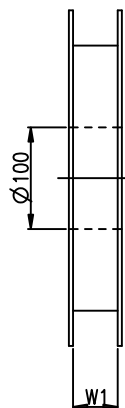

| PIN | B0 | F | S | W | W1 | PIN | B0 | F | S | W | W1 |
|------|-------|-------|----|-------|-------|------|-------|-------|-------|-------|-------|
| 2x04 | 6.85 | 7.50 | -- | 16.00 | 16.50 | 2x10 | 12.85 | 11.50 | -- | 24.00 | 24.50 |
| 2x05 | 7.85 | 7.50 | -- | 16.00 | 16.50 | 2x11 | 13.85 | 11.50 | -- | 24.00 | 24.50 |
| 2x06 | 8.85 | 7.50 | -- | 16.00 | 16.50 | 2x12 | 14.85 | 11.50 | -- | 24.00 | 24.50 |
| 2x07 | 9.85 | 11.50 | -- | 24.00 | 24.50 | 2x15 | 17.85 | 14.20 | 28.40 | 32.00 | 32.50 |
| 2x08 | 10.85 | 11.50 | -- | 24.00 | 24.50 | 2x20 | 22.85 | 20.20 | 40.40 | 44.00 | 44.50 |

- 10 SPROCKET HOLE PITCH CUMULATIVE TOLERANCE ± 0.20
- CARRIER CAMBER IS WITHIN 1 mm IN 250 mm
- THE TOTAL TEARING CONTROL RANGE OF TOP COVER TAPE IS 10~130g, REFERENCE SPEC: EIA-481-D
- PEELING SPEED: 300mm/MINUTES, REFERENCE SPEC: EIA-481-D
- MATERIAL: TRANSPARENT CONDUCTIVE POLYSTYRENE ALLOY.(UP-5000)
- ALL DIMENSIONS MEET EIA-481-D REQUIREMENTS
- THICKNESS : 0.40 ± 0.05 mm
- COMPONENT LOAD PER 13" REEL : 1000 PCS

NOTE: ALL DIMENSIONS AND NOTES MARKED * ARE CRITICAL AND MUST BE CHECKED IN ACCORDANCE WITH QUALITY DOC. QI-02A

| | | | |
|-------|---|----------|------|
| Leo | 9 | 22.05.19 | A541 |
| Leo | 8 | 08.02.18 | A532 |
| Allan | 7 | 28.07.09 | A225 |
| Allan | 6 | 06.10.08 | A166 |
| Allan | 5 | 25.06.08 | A136 |
| Allan | 4 | 25.06.08 | A132 |
| Allan | 3 | 19.06.08 | A130 |
| Allan | 2 | 29.06.07 | A056 |
| Allan | 1 | 01.08.06 | -- |

| NAME | ISS. | DATE | C/NOTE |
|------|------|------|--------|
|------|------|------|--------|

APPROVED: B.Lim

CHECKED: D.P

DRAWN: Leo

CUSTOMER REF.:

ASSEMBLY DRG:

HARWIN

HARWIN USA
TEL: 603 893 5376
FAX: 603 893 5396
mis@harwin.com

HARWIN Europe (UK)
TEL: 023 9231 4545
FAX: 023 9231 4590
mis@harwin.co.uk

HARWIN Asia
TEL: +65 6 779 4909
FAX: +65 6 779 3868
mis@harwin.com.sg

THIS DRAWING AND ANY INFORMATION OR DESCRIPTIVE MATTER SET OUT HEREON ARE CONFIDENTIAL AND COPYRIGHT PROPERTY OF THE HARWIN GROUP AND MUST NOT BE DISCLOSED, LOANED, COPIED OR USED FOR MANUFACTURING, TENDERING OR FOR ANY OTHER PURPOSE WITHOUT THEIR WRITTEN PERMISSION.

TOLERANCES
X. = ± 1 mm
X.X = ± 0.25 mm
X.XX = ± 0.15 mm
X.XXX = ± 0.08 mm
ANGLES = $\pm 5^\circ$
UNLESS STATED

MATERIAL: SEE NOTES
FINISH: SEE NOTES
S/AREA: mm²

TITLE:
WAFER 1.00mm DIL SMT TYPE

DRAWING NUMBER:
M40-302 XX 46 X

SHT
2
OF
2

Mouser Electronics

Authorized Distributor

Click to View Pricing, Inventory, Delivery & Lifecycle Information:

[Harwin:](#)

[M40-3021046R](#)