

PRODUCT DESCRIPTION CODE :

10131937-YXXXLF

PLATING :
 ———— R_oHS COMPATIBLE, SEE NOTE 3
 ———— PACKAGING : "A" : TAPE & REEL
 "U" : TUBE
 ———— TOTAL NUMBER OF POSITIONS 04 TO 50

- 1 = 0.76 µm GOLD ON CONTACT AREA
2.54µm MIN MATTE TIN ON TAIL
- 2 = 0.38µm GOLD ON CONTACT AREA
2.54µm MIN MATTE TIN ON TAIL
- 3 = 0.20µm GOLD ON CONTACT AREA
2.54µm MIN MATTE TIN ON TAIL
- 4 = 0.76 µm GXT ON CONTACT AREA
2.54µm MIN MATTE TIN ON TAIL
- 5 = 0.38µm GXT ON CONTACT AREA
2.54µm MIN MATTE TIN ON TAIL
- 6 = 0.20µm GXT ON CONTACT AREA
2.54µm MIN MATTE TIN ON TAIL
- 9 = 2.54µm MIN MATTE TIN FULL PLATED
- 1.27µm NICKEL MIN UNDERLAYER

NOTES :

1- MATERIAL
 HOUSING : HIGH TEMPERATURE GLASS FILLED FLAME
 RETARDANT PER UL 94 V-0
 TERMINAL: COPPER ALLOY

2- TO DETERMINE DIMENSIONS :
 N = NUMBER OF POSITIONS PER ROW
 EXAMPLE : 8 POS N x 2 = 16mm
 UP TO N = 24 TOLERANCE : 0
 -0.10
 FROM N = 26 TOLERANCE : 0.05
 -0.10

3 - R_oHS COMPATIBLE PRODUCT SPECIFICATIONS
 a - PLATING :
 "LF" MEANS THE PRODUCT IS LEAD-FREE, 2µm MINIMUM
 MATTE TIN OVER 1.27µm MINIMUM NICKEL UNDERPLATE
 b - MANUFACTURING PROCESS COMPATIBILITY
 THE HOUSING WILL WITHSTAND EXPOSURE TO 260°C PEAK
 TEMPERATURE FOR 30 SECONDS MAX IN A CONVECTION,
 INFRA-RED OR VAPOR PHASE OR REFLOW OVEN
 c - LABELLING :
 MEETS PACKAGING SPECS AS PER GS-14-920
 d - LEGAL STATEMENT : SEE GS-47-0004

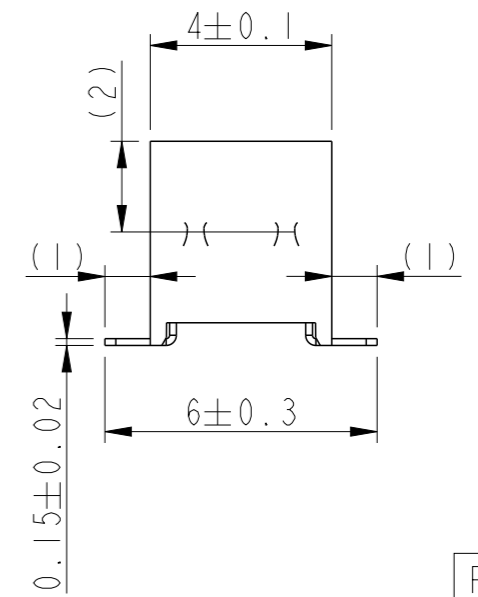
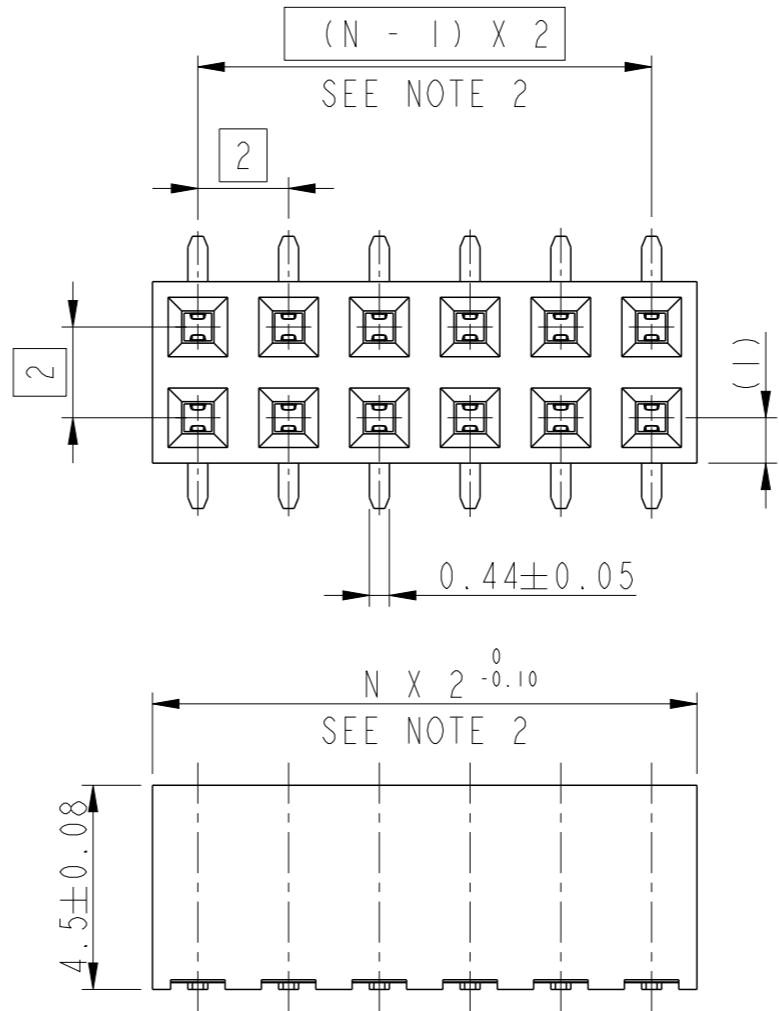
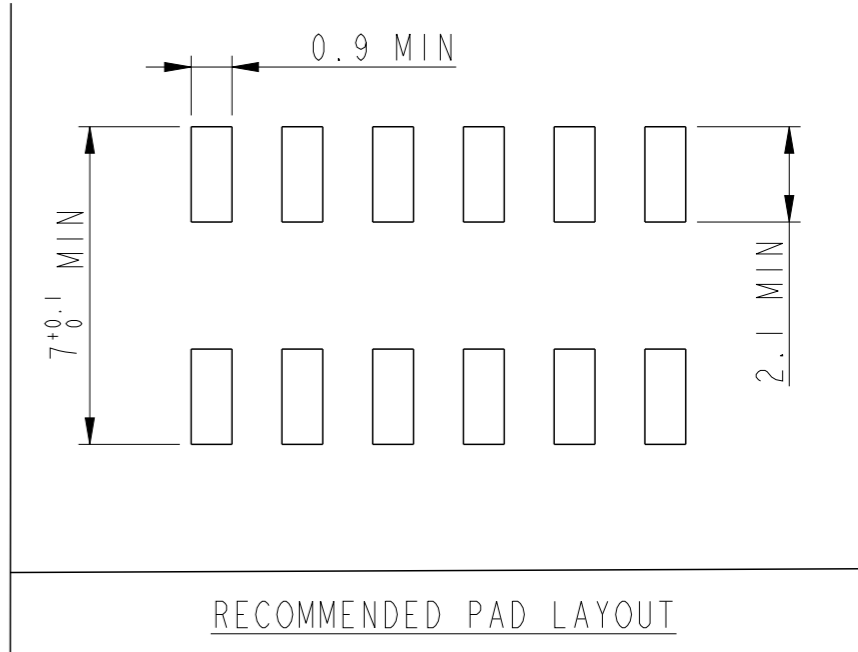

PRELIMINARY

spec ref	GS-12-1326	dr	Cyril Jeune	2014/12/02	projection	mm	size	A3	scale	6:1	
tolerance std	ISO 406 ISO 1101	eng	Benoit Vernier	2015/11/16		mm	ecn no	-	rel level	Preliminary	
TOLERANCES UNLESS OTHERWISE SPECIFIED		chr	-	-							
surface	ISO 1302	appr	-	-	product family	-	rel level	Preliminary			
linear	0.X ± 0.XX ± 0.XXX ±			title	MINITEK RECEPTACLE 2MM ASSEMBLY VCC DR SMT		dwg no	10131937		rev	2
angular	0° ±°	www.fci.com		cat. no.	-	Product - Customer Drw	sheet 1 of 1				



Copyright FCI.

Mouser Electronics

Authorized Distributor

Click to View Pricing, Inventory, Delivery & Lifecycle Information:

[FCI / Amphenol:](#)

[10131937-310ALF](#)