

PRODUCT NO
10046971-040LF

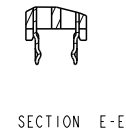

- NOTE:
 1. Material:
 HOUSING: HIGH TEMPERATURE THERMOPLASTIC,
 UL 94 V-0 FLAME RETARDANT.
 TERMINAL: HIGH CONDUCTIVITY COPPER ALLOY.
 PLATING SPEC AS BELOW:
 Ni 50u" UNDER PLATED.
 Au 30u" OVER CONTACT AREA. (ONE SIDE)
 Matte Tin 120u" OVER SOLDERING AREA.
 2. PACKING SPEC: GS-14-937
 3. PRODUCT SPEC: GS-12-338.

spec ref	*	dr	Wei-Long Zhang	2012/03/01	projection 	MM ←→	size	A4	scale	1.000		
tolerance std	TOLERANCES UNLESS OTHERWISE SPECIFIED	eng	Wei-Long Zhang	2012/03/19			product family	ecn no	-	rel level	Released	
		chr	-	-								
surface	✓	appr	Pei-Ming Zheng	2012/03/19	title		VERT 35X2 POWER EDGE CARD		dwg no	10046971-040	rev	A
	linear	0.X	±0.50	www.fci.com	cat. no.		*	Product - Customer Drw		sheet 1 of 2		
		0.XX	±0.25									
		0.XXX	±0.13									
	angular	0°	± 2°									

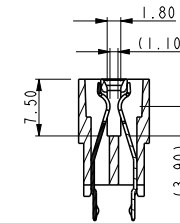
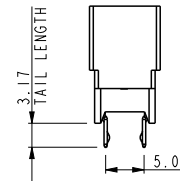
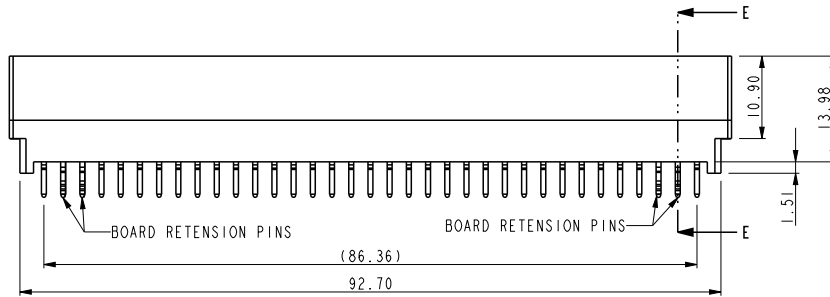
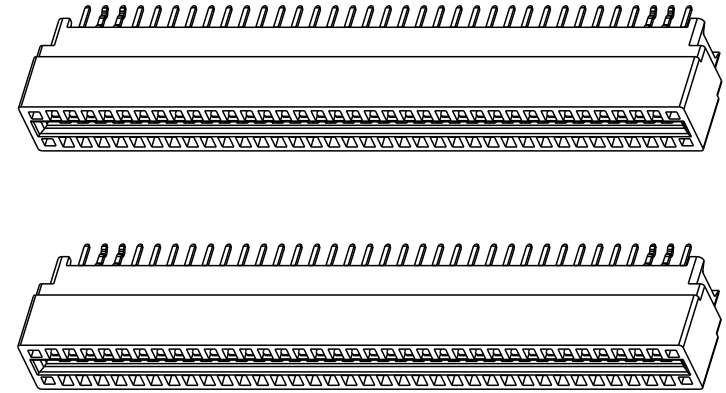
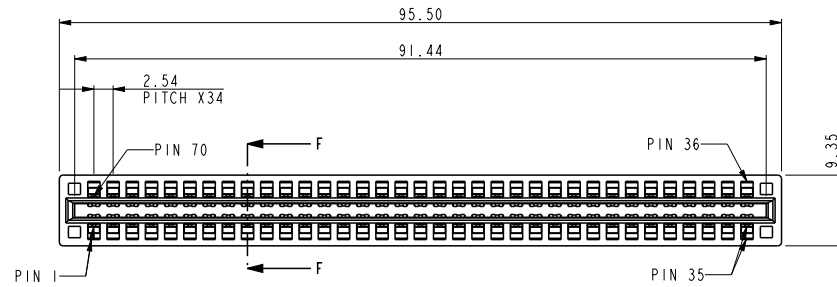

Copyright FCI.

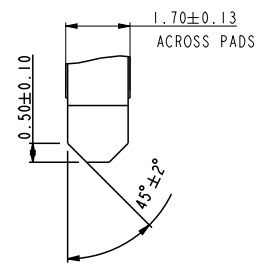
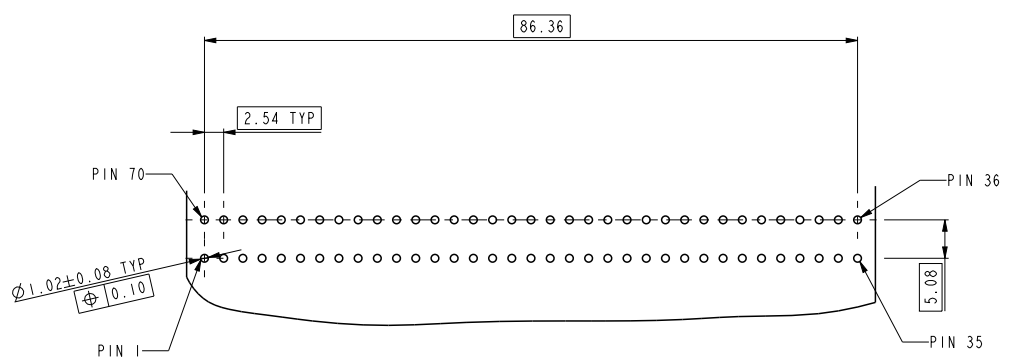
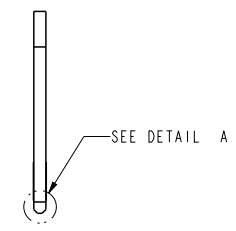
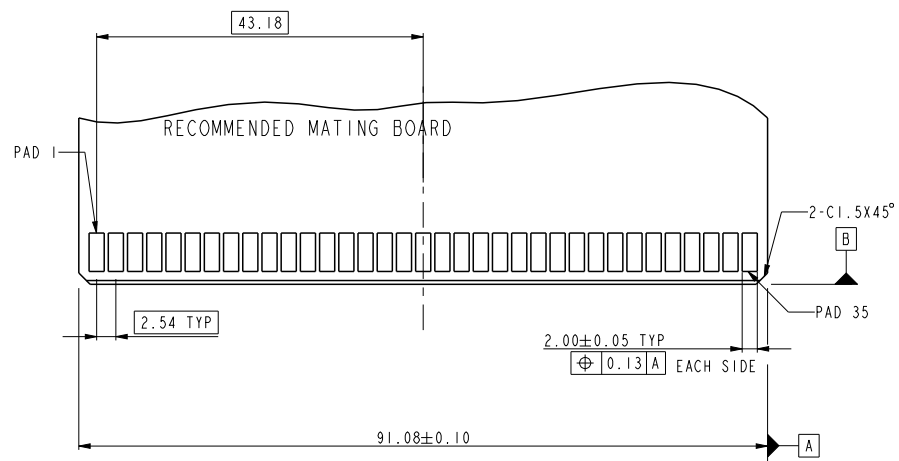

DETAIL A
SCALE 5.000

RECOMMENDED PC BOARD LAYOUT
AND THE THICKNESS IS 2.36mm

spec ref	*	dr	Wei-Long Zhang	2012/03/01	projection 	MM ←→	size	A4	scale	1.000
tolerance std	TOLERANCES UNLESS OTHERWISE SPECIFIED	eng	Wei-Long Zhang	2012/03/19			ecn no	-		
		chr	-	-						
surface	linear	0.X	±0.50	FCI	product family	rel level	Released			
		0.XX	±0.25				10046971-040	rev	A	
		0.XXX	±0.13							
angular	0°	±2°	www.fci.com	cat. no.	*	Product - Customer Drw	sheet 2 of 2			

ProjE File - REV C - 2009-06-09

Mouser Electronics

Authorized Distributor

Click to View Pricing, Inventory, Delivery & Lifecycle Information:

[FCI / Amphenol:](#)

[10046971-040LF](#)