

THIS COPYRIGHTED DOCUMENT IS THE PROPERTY OF GLENDALE, INC. AND IS FURNISHED ON THE CONDITION THAT IT IS NOT TO BE DISCLOSED, REPRODUCED IN WHOLE OR IN PART, OR USED TO SOLICIT QUOTATIONS FROM COMPETITIVE SOURCES, OR USED FOR MANUFACTURE BY ANYONE OTHER THAN GLENDALE, INC. WITHOUT WRITTEN PERMISSION FROM GLENDALE, INC. THE INFORMATION HEREIN HAS BEEN DEVELOPED AT GLENDALE'S EXPENSE AND MAY BE USED FOR ENGINEERING EVALUATION AND INCORPORATION INTO TECHNICAL SPECIFICATIONS AND OTHER DOCUMENTS WHICH SPECIFY PROCUREMENT OF PRODUCTS FROM GLENDALE, INC.

REVISIONS				
REV.	DESCRIPTION	ENG	BY	DATE
A	FULLY RELEASED	DDA	DDA	09/17/2013
B	REVISED PER DCN 60468	JCC	JCC	6/2/2016
C	REVISED PER DCN 67147	JCC	JCC	10/5/17

1ST DIGIT	SIZE 23 CONTACT	2ND DIGIT	MICRO CONTACT	3RD DIGIT	NANO CONTACT
0	ZERO IF NONE	0	ZERO IF NONE	0	ZERO IF NONE
1	22 AWG	2	24 AWG	4	28 AWG
2	24 AWG	3	26 AWG	5	30 AWG
3	26 AWG	4	28 AWG	6	32 AWG
4	28 AWG	5	30 AWG		

TABLE 2

EXAMPLE: 880-003R A - F4W4N - MT 305 J 1 - 18

SERIES 88: _____
 QUICK DISCONNECT (880)
 FRONT PANEL MOUNT RECEPTACLE (-003R)

INSERT CONFIG. _____
 A = UNSHROUDED CONTACTS
 (EX: MICRO SOCKET)
 B = SHROUDED CONTACTS
 (EX: MICRO TWIST PIN)

SHELL SIZE-INSERT/CONTACT ARRANGEMENT _____
 (SEE DWG NUMBER 889-001)

SHELL MATERIAL/FINISH _____
 (TABLE 1)

WIRE AWG _____
 (TABLE 2)

WIRE TYPE _____
 J = "SPACE GRADE" WIRE M22759/33 OR EQUIV. (ETFE)
 K = "NON-SPACE" WIRE M22759/11 OR EQUIV. (PTFE)

WIRE COLOR CODE _____
 1 = WHITE
 5 = COLOR CODED MIL-STD-681
 7 = TEN COLOR REPEATING

WIRE LENGTH (IN) _____
 "18" SPECIFIES 18 INCHES

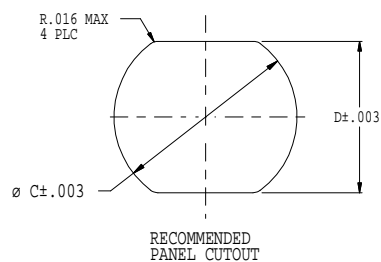

SHELL SIZE	A MAX OD	B REAR OD	C MOUNT DIA	D FLATS
B	.392	.214	.285	.241
C	.412	.239	.305	.261
D	.432	.252	.324	.281
E	.451	.278	.344	.301
F	.471	.297	.364	.320
G	.490	.319	.383	.340
H	.530	.356	.423	.379
J	.569	.384	.462	.419
K	.589	.406	.481	.438
L	.628	.445	.521	.478

FINISH	MATERIAL	FINISH DESCRIPTION
M	ALUMINUM ALLOY	ELECTROLESS NICKEL
ZR		BLACK ZINC-NICKEL OVER E/N
MT		NICKEL TEFLON
NF		OLIVE DRAB OVER CAD
ZC	STAINLESS STEEL	BLACK ZINC COBALT
ZK		PASSIVATE
ZMT		NICKEL TEFLON

TABLE 1

'L' +1.00/- .00

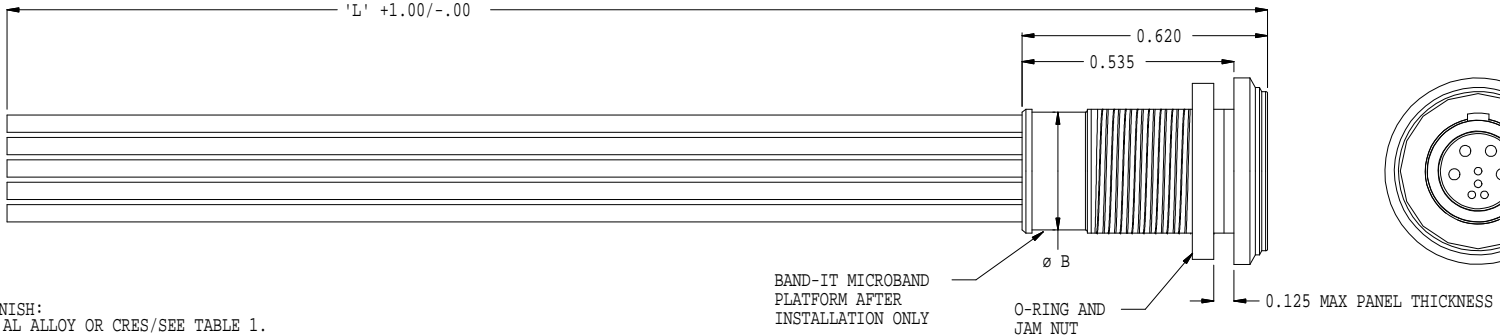

- MATERIAL / FINISH:
 SHELL - AL ALLOY OR CRES/SEE TABLE 1.
 INSULATOR - LCP OR EQUIV.
 EPOXY ENCAPSULANT: HYSOL EE4215/HD3516
 CONTACTS - COPPER ALLOY / GOLD PLATE PER ASTM B 488, TYPE 3, CLASS 1.25 (.00005 MIN THK), OVER A SUITABLE UNDERPLATE.
 O-RING: FLUOROSILICONE OR EQUIV.
 LATCHING EMI SPRING - SST / GOLD PLATED
- ASSEMBLY TO BE IDENTIFIED WITH GLENNAIR'S NAME PART NUMBER AND DATE CODE SPACE PERMITTING.

NOTES: UNLESS OTHERWISE SPECIFIED

UNLESS OTHERWISE SPECIFIED	DRAWN	BC	5/31/2012	GLENNAIR, INC. 1211 AIR WAY GLENDALE, CA 91201 -SERIES 88- SUPERFLY QUICK DISCONNECT (880) FRONT PANEL MOUNT RECEPTACLE
DIMENSIONS ARE IN INCHES	CHECK	CLM	5/31/2012	
TOLERANCES:	ENGR.	CLM	3/14/2012	
FRACTIONS ± 1/16	APPROVED			CAGE CODE
DECIMALS .XX ± .025 .XXX ± .010				RELEASE DATE
ANGLES ± 5°	INTERPRET GD&T IN ANSI Y14.5M-1982	B/F	P/C 88	DWG. NUMBER
	THIRD ANGLE PROJECTION			880-003
				REV.
				C
		SCALE	N/A	WEIGHT
			N/A	SHEET
				1 OF 1

Mouser Electronics

Authorized Distributor

Click to View Pricing, Inventory, Delivery & Lifecycle Information:

[Glenair:](#)

[880-003RA-K19M-NF040K5-15](#)