

SPECIFICATIONS

ELECTRICAL

RESISTANCE RANGE _____ 1/2 OHM TO 300K OHM
RESISTANCE TOLERANCE _____ ±5%
LINEARITY, INDEPENDENT _____ SEE CHART
RESOLUTION _____ SEE CHART
END RESISTANCE _____ 1 OHM OR 1%
ELECTRICAL TRAVEL _____ SEE CHART
NOISE _____ 100 OHMS MAX
POWER RATING _____ SEE CHART
INSULATION RESISTANCE _____ 100 MEGOHMS AT 1000 VDC MIN.
DIELECTRIC STRENGTH _____ 1000 VAC MIN.

MECHANICAL

NUMBER OF TURNS _____ SEE CHART
MECHANICAL TRAVEL _____ SEE CHART
TORQUE, ROTATIONAL _____ 2.8 OZ.IN.
SHAFT END PLAY _____ .005 T.I.R.
LIFE (SHAFT REVOLUTIONS) _____ SEE CHART
STOP STRENGTH _____ 125 OZ.IN. MIN.

ENVIRONMENTAL

OPERATING TEMPERATURE _____ -55°C TO +105°C
TEMPERATURE COEFFICIENT _____ SEE CHART
VIBRATION _____ 10HZ TO 2000HZ 15G
SHOCK _____ 50G 11MS
MOISTURE RESISTANCE _____ 40°C 95%RH 120 HOURS

OPTIONS

SPECIAL SHAFTS _____ BALL BEARINGS
SERVO MOUNT _____ SPECIAL LINEARITY
DUAL GANGS _____ SPECIAL RESISTANCES

REV.	BY	DATE	PART NO.
E	BT	10-2-00	MR46B
			TERMINALS WERE GOLD PLATED

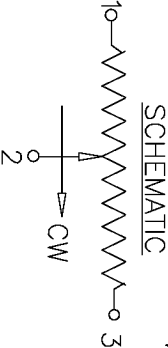
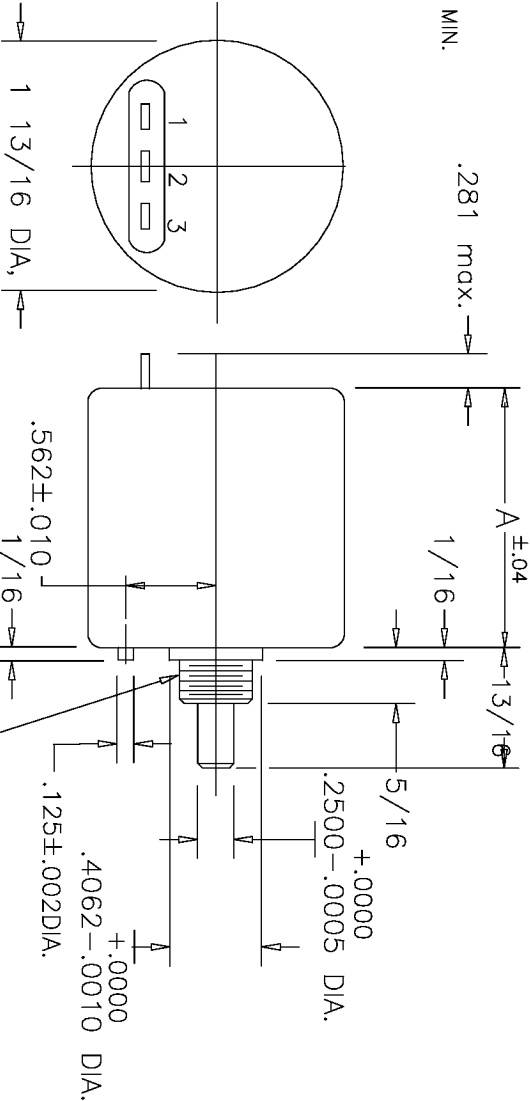

% RESOLUTION AND TEMPERATURE COEFFICIENT CHART

# SLIDEWIRE (INFINITE RESOLUTION)												
RESIS. MODEL	.5	1	2	5	10	20	50	100	200	50K	1K	2K
-3	#	#	#	#	#	#	#	#	#	#	#	#
-5	#	#	#	#	#	#	#	#	#	#	#	#
-10	#	#	#	#	#	#	#	#	#	#	#	#

ELECTRICAL TRAVEL	MECHANICAL TRAVEL	LINEARITY (IND.)	NO. OF TURNS	POWER RATING @ 40°C	ROTATIONAL LIFE (TURNS)	WEIGHT	DIM.
1080 ±5°	1080 ±10° - 0° 0.5%		3	2 WATTS	600,000	2.8 OZ.	1.50
1800 ±5°	1800 ±10° - 0° 0.5%		5	2.5 WATTS	1,000,000	3.2 OZ.	1.50
3600 ±5°	3600 ±10° - 0° 0.25%		10	5 WATTS	2,000,000	4.2 OZ.	2.20

MATERIAL

HOUSING _____ ALUMINUM, ANODIZED
SERVO LID _____ ALUMINUM, ANODIZED
SHAFT _____ STAINLESS STEEL
TERMINALS _____ SILVER PLATED
BEARINGS _____ BUSHING

TOLERANCES

XX = +/- .010" FRACT. = +/- 1/64"
XXX = +/- .005" ANGLES = +/- 1/2°
ALL SPECIFICATIONS SUBJECT TO CHANGE WITHOUT NOTICE.

THIS DOCUMENT CONTAINS PROPRIETARY DATA OF POLARIS INDUSTRIAL ENTERPRISES, INC. NO DISCLOSURE, REPRODUCTION, OR USE OF ANY PART THERE OF MAY BE MADE EXCEPT BY WRITTEN PERMISSION.

TITLE

WIREWOUND
MULTI-TURN
POTENTIOMETER

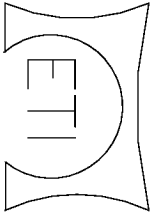

SYSTEMS

CARLSBAD
CALIFORNIA

PART NO.

MR46B

Mouser Electronics

Authorized Distributor

Click to View Pricing, Inventory, Delivery & Lifecycle Information:

[ETI Systems:](#)

[MR46B-20-1K](#)