

O.P. (MM)	P.T. (MM)
9.1 ±0.8	3.6 MAX

O.P. = OPERATING POINT
P.T. = PER-TRAVEL

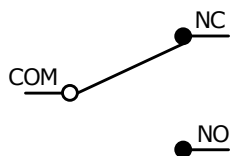

CIRCUIT: SPDT

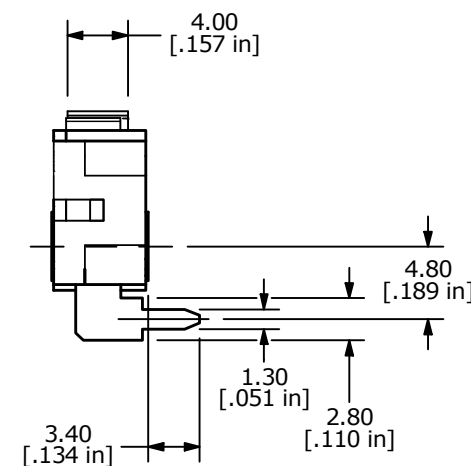
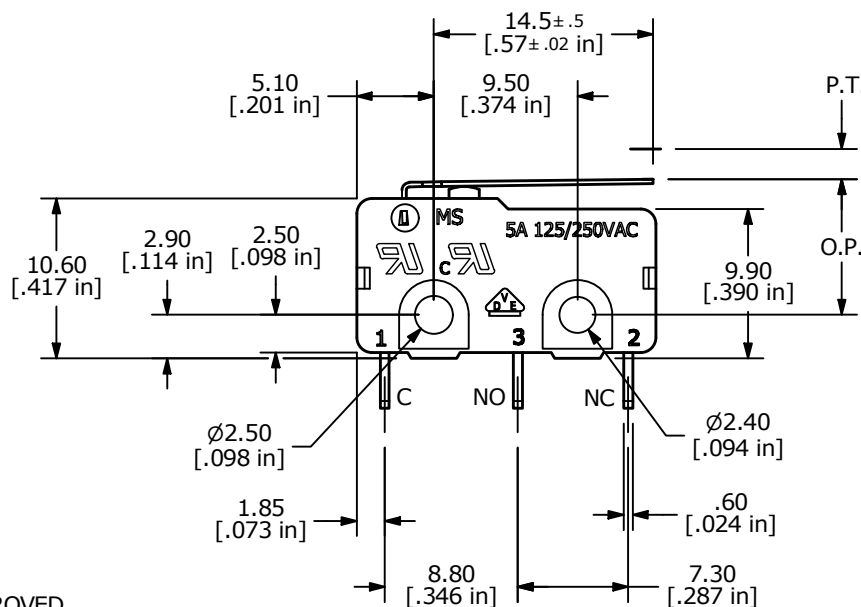

- NOTES:
1. ALL DIMENSIONS IN MM [INCH]
 2. GENERAL TOLERANCE: X.X ± 0.4
X.XX ± 0.25
 3. RATING: 5A @125/250VAC UL, CUL, VDE APPROVED
 - ▲ 4. OPERATING FORCE: 20 ± 12 GRAMS
 5. OPERATING TEMP: -25°C to 85°C
 6. ELECTRICAL LIFE: 50,000 CYCLES MIN.
 7. MECHANICAL LIFE: 1,000,000 CYCLES TYP.
 8. INSULATION RESISTANCE: 100 MEGA-OHMS
 9. DIELECTRIC STRENGTH: 1000VAC 1 MINUTE (INITIAL VALUE)
 10. CONTACT RESISTANCE: 100 mΩ MAX.
 11. ▲ DENOTES CRITICAL PARAMETER.



A	24355	RELEASE	6/22/20	MW
REV	PCR NO	DESCRIPTION	DATE	BY

TITLE MS0850501F020V1A				
SCALE	DATE	DR	DWG	REV
2:1	6/18/2020	MW	Q970176	A

THE INFORMATION CONTAINED IN THIS DOCUMENT IS PROPRIETARY TO E-SWITCH AND IS NOT TO BE COPIED OR TRANSFERRED

Mouser Electronics

Authorized Distributor

Click to View Pricing, Inventory, Delivery & Lifecycle Information:

[E-Switch:](#)

[MS0850501F020V1A](#)