

PCB LAYOUT

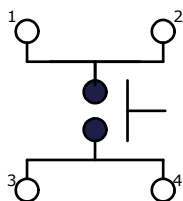

CIRCUIT DIAGRAM: SPST

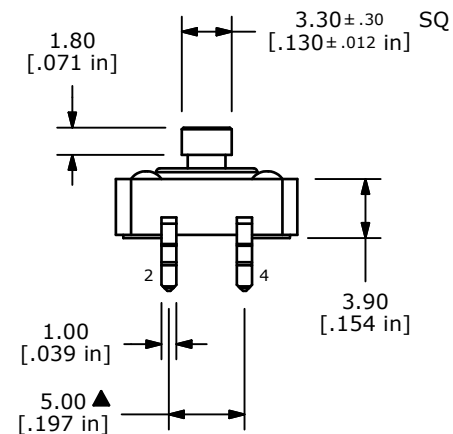
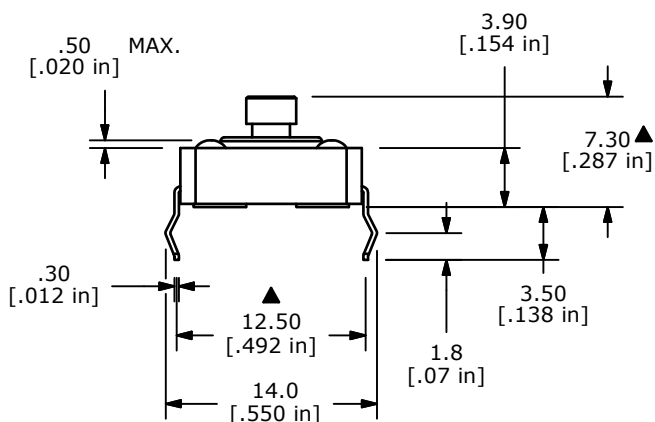
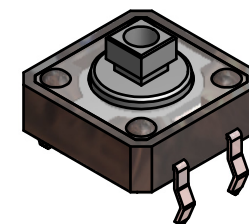
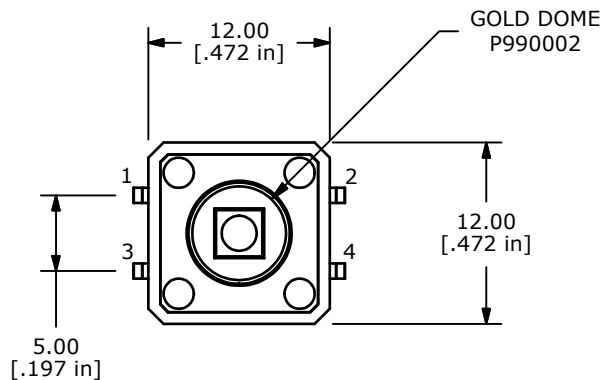

NOTES:

1. ALL DIMENSIONS IN mm [INCH]
2. GENERAL TOLERANCE: X.X=±0.4
X.XX=±0.25
3. TERM. NOS. FOR REFERENCE ONLY.
4. RATING: 50mA @ 12VDC
- ▲ 5. OPERATING FORCE: 160 ± 50 grams
6. TRAVEL: 0.3mm ±0.15
7. CONTACT RESISTANCE: 100 MILLI OHMS MAX. (INITIAL)
8. MECHANICAL/ELECTRICAL LIFE 100,000 CYCLES MIN.
- ▲ 9. CONTACT MATERIAL: GOLD
10. 2002/95/EC (ROHS) COMPLIANT
11. ▲ DENOTES CRITICAL PARAMETER



B	21560	Chg P990001 to P990002	8/27/14	rc
A	21554	INITIAL RELEASE	8/21/14	EBP
REV	PCR NO	DESCRIPTION	DATE	BY

TITLE TL1100F160R				
SCALE	DATE	DR	DWG	REV
	8/21/2014	EBP	P001179	B

THE INFORMATION CONTAINED IN THIS DOCUMENT IS PROPRIETARY TO E-SWITCH AND IS NOT TO BE COPIED OR TRANSFERRED

Mouser Electronics

Authorized Distributor

Click to View Pricing, Inventory, Delivery & Lifecycle Information:

[E-Switch:](#)

[TL1100F160R](#)