

▲ CIRCUIT: SPST
OFF - (ON)
(MOMENTARY)

TERMINAL	WIRE
1	WIRE, 20 AWG, BLACK
2	WIRE, 20 AWG, BLACK
3 (-)	WIRE, 20 AWG, GREEN
4 (+)	WIRE, 20 AWG, RED

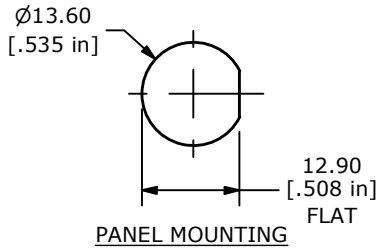
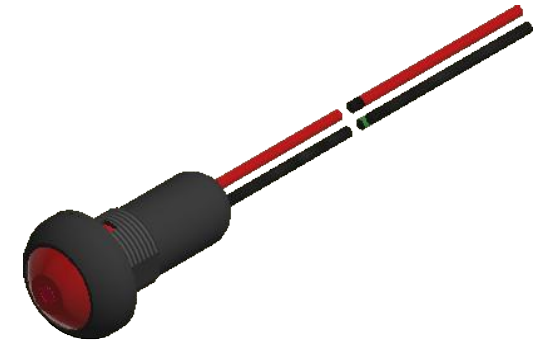

▲ WINDOW TO VIEW RED LED

Ø17.50
[Ø.69 in]
Ø12.00
[Ø.472 in]

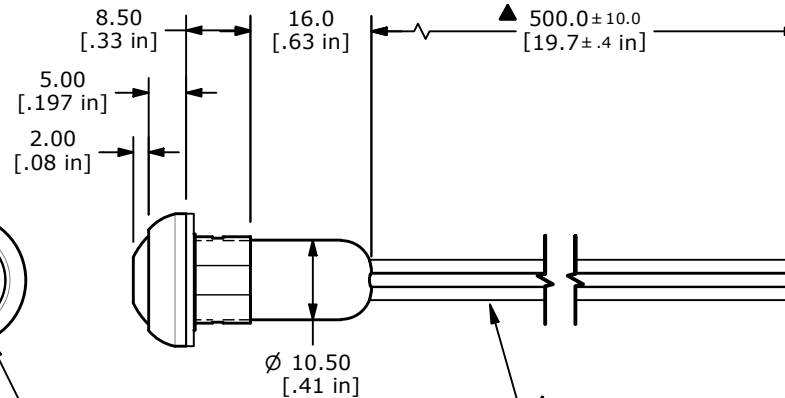

▲ SWITCH
HOUSING COLOR - BLACK
CAP (ACTUATOR) COLOR - RED
LED COLOR - RED

▲ MOLDED ON WIRES
(4) WIRES, 20 AWG

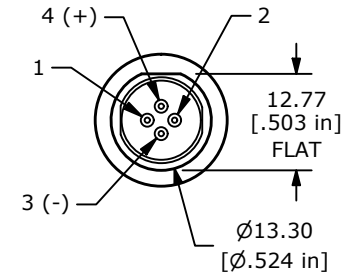

BOTTOM VIEW
(SHOWN WITHOUT
RUBBER SEAL)

NOTE:

- ALL DIMENSIONS IN MM [INCH]
- GENERAL TOLERANCE: X.X = ±0.4
X.XX = ±0.25
- TERMINAL NUMBERS FOR REF ONLY
- CIRCUIT: SPST OFF-MOMENTARY ON
- CONTACT MATERIAL: Gold over SILVER
- RATING: 125mA @ 125 VAC
100mA @ 50 VDC
- ELECTRIC LIFE: 500,000 CYCLES AT FULL LOAD
- CONTACT RESISTANCE: 50 MILLI-OHM MAX. (INITIAL)
- INSULATION RESISTANCE: 1,000 MEGA-OHM MIN. @ 500VDC
- DIELECTRIC STRENGTH: 1,000 VAC FOR 1 MINUTE
- OPERATING FORCE: 350 ±150gf
- OPERATING TEMPERATURE: -30°C to +85°C
- CONTACT BOUNCE: 10ms MAX.
- TRAVEL: 1.5mm
- PANEL THICKNESS RANGE: 1.5 - 4.0mm
- ▲ DENOTES CRITICAL PARAMETER.
- MAX TORQUE APPLIED TO MOUNTING NUT: 0.5Nm
- ▲ 18. HARDWARE INCLUDED:
 - T081101 LOCK WASHER (Qty 1)
 - T081102 HEX NUT (Qty 1)
 - T081100 RUBBER SEAL (Qty 1)
- SEAL RATING: IP67 AT THE FRONT PANEL

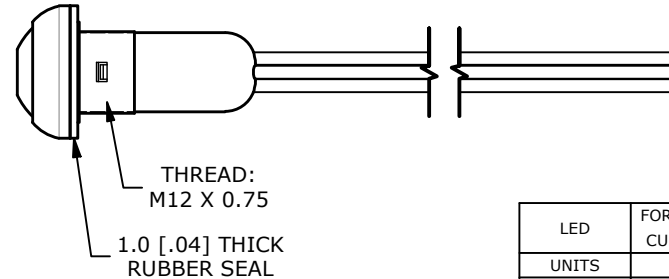

LED	FORWARD CURRENT	FORWARD VOLTAGE @ 20mA	LUMINOUS INTENSITY
UNITS	mA	V	mcd
RED	20	2.0 - 2.5	700

REV	ECO NO	DESCRIPTION	DATE	BY	E-SWITCH®				OBJECT ID
A	ECO-100256	Release	09/22/21	JM	TITLE RP8100B2W1CEBLKREDRED				100117694
					SCALE	DATE	DR	DWG	REV
					1:1	8/3/2021	MW	ST081503	A

THE INFORMATION CONTAINED IN THIS DOCUMENT IS PROPRIETARY TO E-SWITCH AND IS NOT TO BE COPIED OR TRANSFERRED

Mouser Electronics

Authorized Distributor

Click to View Pricing, Inventory, Delivery & Lifecycle Information:

[E-Switch:](#)

[RP8100B2W1CEBLKREDRED](#)