

ITEM	QTY	PART NUMBER	DESCRIPTION
1	1	F060619	LAKEEV11
2	1	F051601	P16 PLASTIC TERM. PROTECTOR
3	1	F050422	24VDC GREEN LED
4	1	F051702	25MM RING
5	1	F060202	25MM GREEN LENS

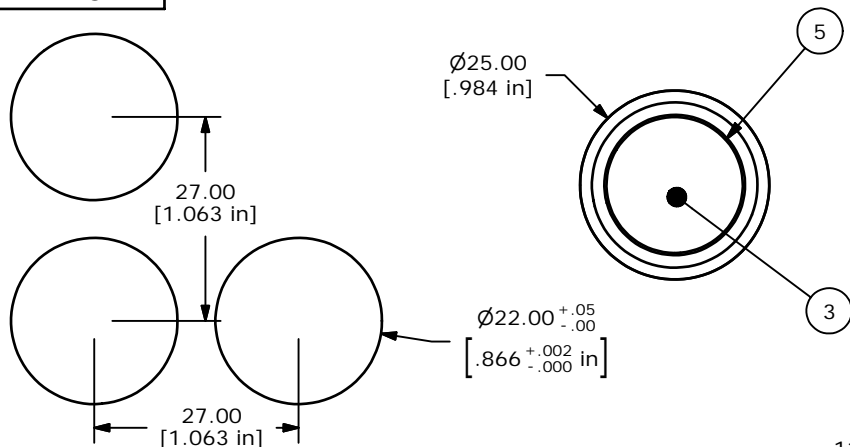

RECOMMEND PANEL MOUNTING

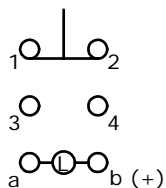

CONTACT CONFIGURATION

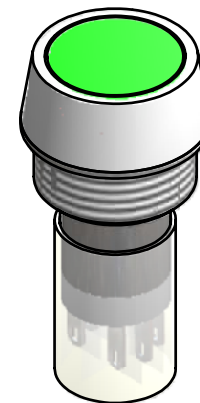
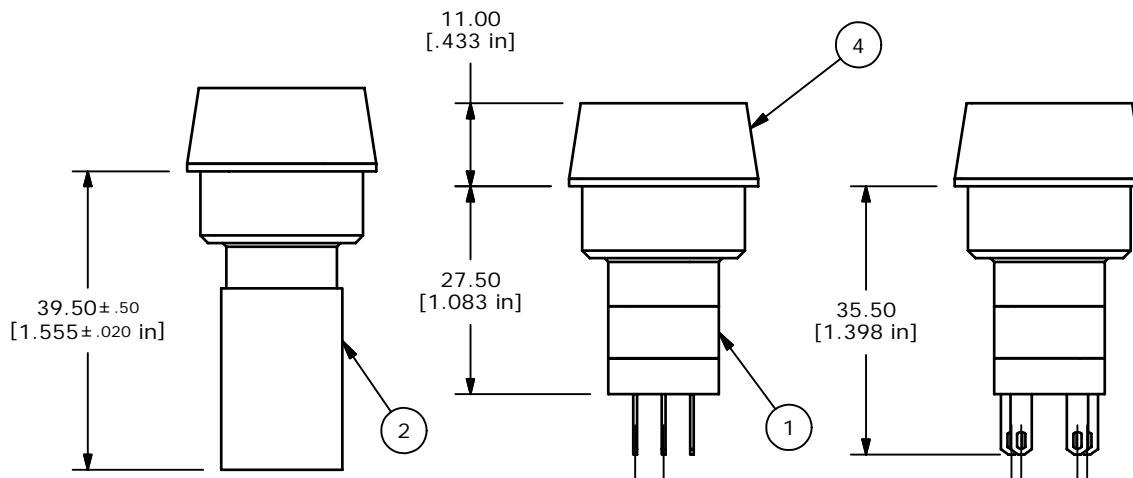

ISOMETRIC

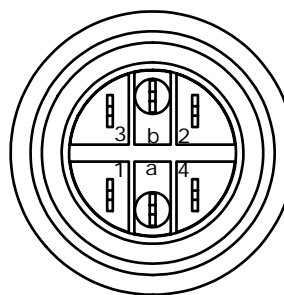

- NOTES:
- ALL DIMENSIONS IN MM [INCH].
  - GENERAL TOLERANCE: 0.0=±0.4  
0.00=±0.25
  - TERM. NOS. FOR REF. ONLY.
  - ▲ RATING: 5A @250VAC  
8A @125VAC  
.2A @250VDC  
6A @24VDC
  - MECHANICAL LIFE: 2,000,000 MAKE-OR-BREAK CYCLES
  - INSULATION: 1,000 MΩ MIN.
  - DIELECTRIC STRENGTH: 2000V FOR 1 MIN
  - OPERATING TEMP: -25°C TO 55°C
  - ▲ LENS COLOR: GREEN
  - ▲ LAMP VOLTAGE: 24VDC LED
  - ▲ PACKAGE: BOX/20 PER BOX
  - 2002/95/EC (ROHS) COMPLIANT
  - ▲ DENOTES MAJOR DIMENSION.

**E-SWITCH®**

TITLE LAKEEV11KGRNGRN

A	16899	RELEASED FOR PRODUCTION	1/22/2007	TN
REV	PCR NO	DESCRIPTION	DATE	BY

SCALE	DATE	DR	DWG	REV
1:1	1/22/2007	TN	XF0707P	A

THE INFORMATION CONTAINED IN THIS DOCUMENT IS PROPRIETARY TO E-SWITCH AND IS NOT TO BE COPIED OR TRANSFERRED

# Mouser Electronics

Authorized Distributor

Click to View Pricing, Inventory, Delivery & Lifecycle Information:

[E-Switch:](#)

[LAKEEV11KGRNGRN](#)