

1.0 ± 0.2  
3.0 ± 0.4  
a-L-b (+)

SPST  
CONTACT CONFIGURATION

NOTES:

1. ALL DIMENSIONS IN MM
2. GENERAL TOLERANCE: X.X=±0.4  
X.XX=±0.25
3. RATINGS: 5A @250V AC  
8A @125V AC
4. CONTACT MATERIAL:  
COPPER ALLOY W/Silver Plating
5. LAMP VOLTAGE: 24V DC GREEN L.E.D.

PARTS LIST			
ITEM	QTY.	PART NO.	PART DESCRIPTION
1	1	F040009	D16 OA R1 1
2	1	F050422	50-004-22 (GRN L.E.D.)
3	1	F050102	50-001-02 (Transparent GRN lens)

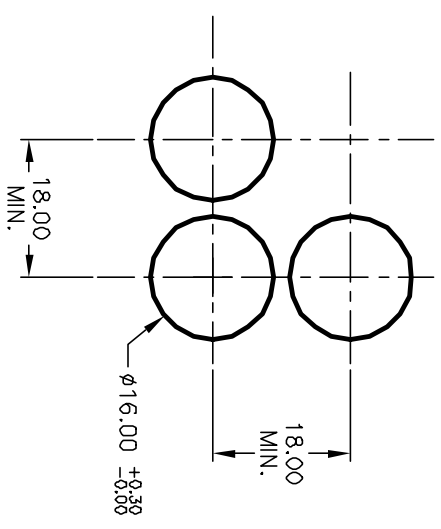

**E-SWITCH®**

REV.	ECN No.	DESCRIPTION	DATE	CHKD
A	12501	RELEASE FOR PRODUCTION	10/22/02	CJB

TITLE	SCALE	DATE	DR	DWG	REV
D16 OA R 1 1K GRN GRN (MOMENTARY) TRANSPARENT /CONCAVE LENS	1.5:1	10/22/02	CB	XF0523P	A

THE INFORMATION CONTAINED IN THIS DOCUMENT IS PROPRIETARY TO E-SWITCH AND IS NOT TO BE COPIED OR TRANSFERRED

# Mouser Electronics

Authorized Distributor

Click to View Pricing, Inventory, Delivery & Lifecycle Information:

[E-Switch:](#)

[D16OAR11KGRNGRN](#)