

▲ SWITCH FUNCTION		
POS. 1	POS. 2	POS. 3
(ON)	OFF	(ON)
(ON)	OPEN	2-1

( ) = DENOTES MOMENTARY

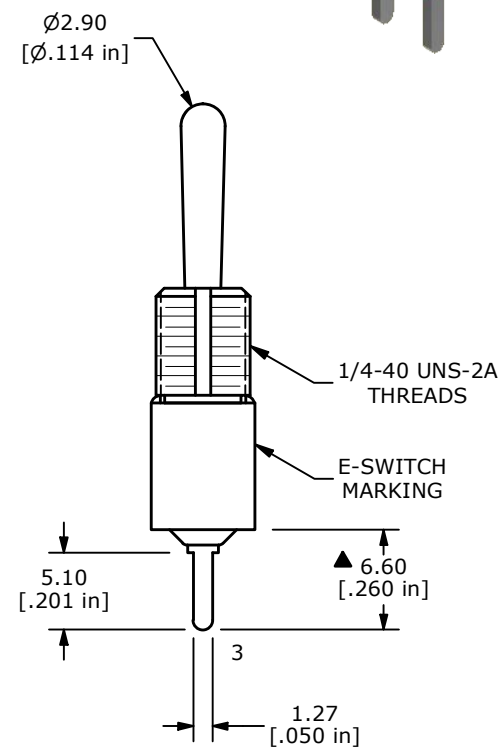
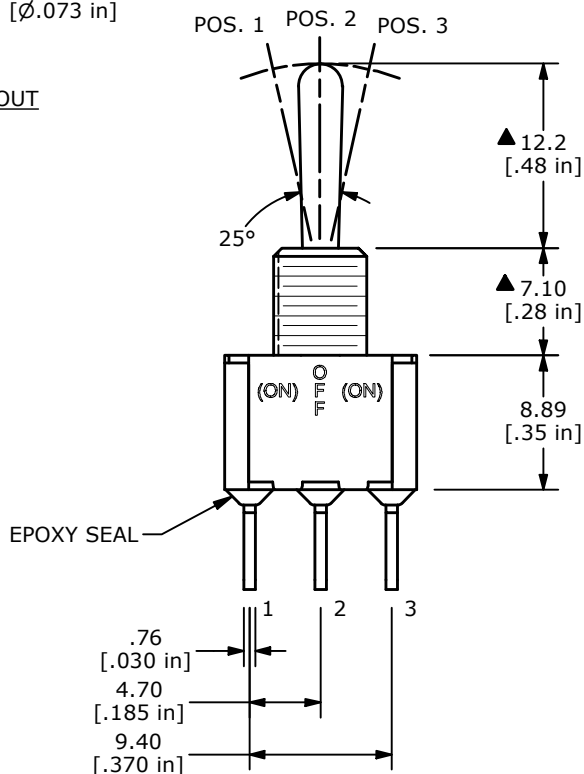
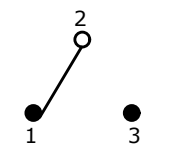
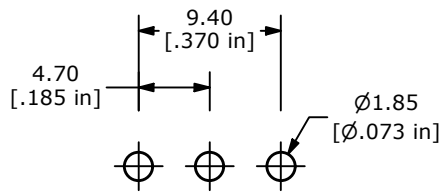

- NOTE:
- ALL DIMENSIONS IN MM [INCH]
  - GENERAL TOLERANCE: X.X=±0.4  
X.XX=±0.25
  - TERMINAL NUMBERS FOR REF ONLY
  - ▲ CONTACT MATERIAL: SILVER
  - RATING: 2A @ 250 VAC  
5A @ 120 VAC OR 28 VDC
  - ELECTRIC LIFE: 6,000 MAKE-AND-BREAK CYCLES AT FULL LOAD.
  - INSULATION RESISTANCE: 1,000 MEGA-OHM MIN.
  - DIELECTRIC STRENGTH: 1,000 V RMS @SEA LEVEL.
  - OPERATING TEMP.: -40°C TO 85°C
  - ▲ DENOTES CRITICAL PARAMETER.
  - HARDWARE TO BE SHIPPED BULK  
T100011 - LOCK WASHER - QTY 1  
T100015 - LOCK RING - QTY 1  
T100000 - HEX NUT - QTY 2

REV	ECO NO	DESCRIPTION	DATE	BY
B	ECO-101927	100 SERIES UPDATE	05/16/23	MR



OBJECT ID  
000023037

TITLE 100SP4T1B3M2QE H				
SCALE 2:1	DATE 12/26/2008	DR BLR	DWG ST114003	REV B

# Mouser Electronics

Authorized Distributor

Click to View Pricing, Inventory, Delivery & Lifecycle Information:

[E-Switch:](#)

[100SP4T1B3M2QEH](#)