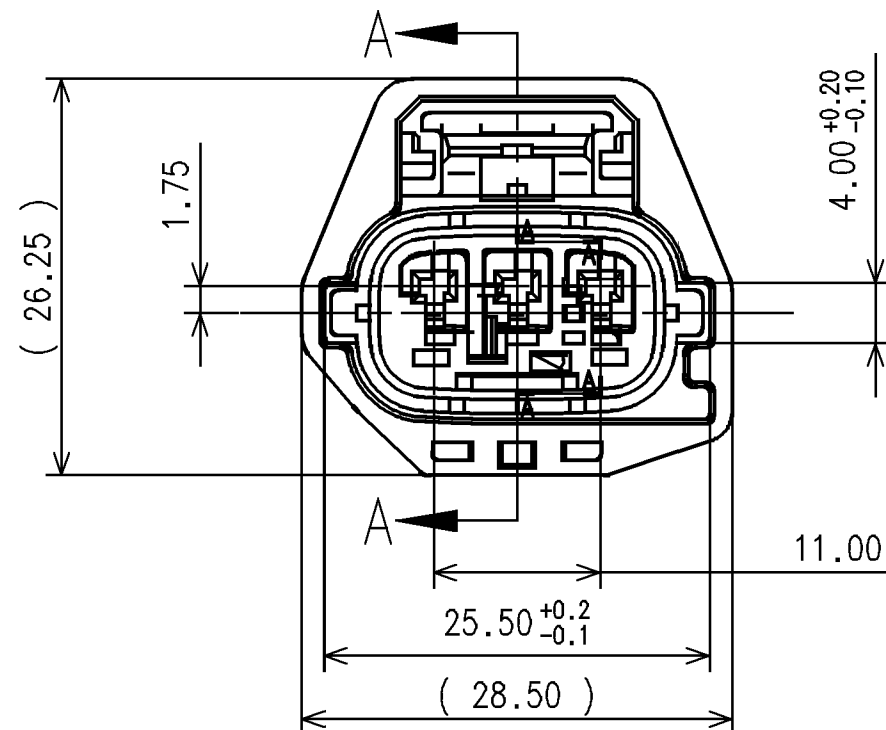

Diagram showing a cross-sectional view of the front of the front plate assembly. Callouts 1, 2, and 3 point to specific components. Dimension lines indicate a distance of $(0.05 \sim 1.35)$ SEE NOTE 9 and a distance of (33.45) .



SECTION A-A

5		6			7			
TABLE 1	SUB ASSEMBLY PART NUMBER	NO.	PART NUMBER	PART NAME		MATERIAL	COLOR	QUANTITY
	7283-2485-30 ETC.	①	SEE TABLE 2	1.5 SYSTEM SEALED CONNECTOR 3P (F) PBT HOUSING		PBT-GF15	SEE TABLE 2	1
		②	7158-4168	1.5 SYSTEM SEALED CONNECTOR 3P (F) FRONT HOLDER		HPA	NATURAL	1
		③	7137-2711-50	1.5 SYSTEM SEALED CONNECTOR 3P PACKING		SILICONE	RED	1
		④	7158-7080-50	CPA FOR SEALED CONNECTOR (1.5, 2.8 AND 6.3 SYSTEM)		HPA	RED	1
	7283-2484-30 ETC.	①	SEE TABLE 2	1.5 SYSTEM SEALED CONNECTOR 3P (F) PBT HOUSING		PBT-GF15	SEE TABLE 2	1
		②	7158-4168	1.5 SYSTEM SEALED CONNECTOR 3P (F) FRONT HOLDER		HPA	NATURAL	1
		③	7137-2711-50	1.5 SYSTEM SEALED CONNECTOR 3P PACKING		SILICONE	RED	1
	TABLE 2	SUB ASSEMBLY PART NUMBER	HOUSING PART NUMBER		KEYWAY	CPA	COLOR	YAZAKI INLINE MATING PART NUMBER
		7283-2484-30	7183-2484-30		A	NO	BLACK	7282-5541-30
7283-2485-30		7183-2484-30		A	YES	BLACK	7282-5541-30	
7287-7769-10 ▲		7187-7769-10		B	NO	DARK GREY	7282-5691-10	
7287-7770-10 ▲		7187-7769-10		B	YES	DARK GREY	7282-5691-10	

NOTES:

1. PARTS MUST BE PURCHASED FROM YAZAKI.
2. PARTS MUST BE FREE OF FLASH AND IMPERFECTIONS THAT AFFECT FUNCTION.
3. APPLICABLE TERMINAL: SEE 7116-4102-02:R DRAWING. (1.5 YESC)
4. APPLICABLE WIRE SEAL: SEE 7158-3030-50:R DRAWING. (1.5 YESC)
5. APPLICABLE CAVITY PLUG: SEE 7158-3032-60:R DRAWING.
6. MATING PART NUMBER: SEE TABLE 2
7. PART DESIGNED TO SATISFY USCAR-2, REVISION 3, APRIL 2001, CLASS 3.
8. PART TO COMPLY WITH YPES-31-038 REQUIREMENTS.
9. THIS DIMENSION SHOWS THE PRE-SET POSITION OF THE TPA.
10. THIS DIMENSION SHOWS THE PRE-SET POSITION OF THE CPA.
11. THIS DRAWING IS TO BE USED FOR INTERNAL YAZAKI PSW SUBMISSION.

△	09-04-2011	ADDED KEYWAY B	C11-A793	MMR
-	07-05-2005	NEW	C05-A706	W.M.
LET	DATE	REVISION RECORD	NO.	CHKD

GENERAL TOLERANCE								VENDOR NO.		3P (F) PBI SUB ASS'Y				
	10MAX	50MAX	100MAX	250MAX	2500VR	ANGLE	ECCENT	DWG TYPE	DWG SOURCE	DWG DATE	UNIT	SCL	ANGLE	PART NO.
A	±0.15	±0.2	±0.3	±0.5	±0.75	±30°	0.1	R	7283-2484-30:M	04.01.04	mm	2/1	3	CH. CODE 7283-2484-30. ETC.
B	±0.2	±0.3	±0.55	±0.95	±1.4	±30°	0.1	APPROVED	CHECKED	CHECKED	DESIGN		DRAWN	DWG NO.
©	±0.3	±0.5	±0.8	±1.4	±2	±30°	0.15				MICHAEL PERRY			7283-2484-30:R
SPECIFIED							MASS				04.01.04			YAZAKI CORPORATION
							g							

Mouser Electronics

Authorized Distributor

Click to View Pricing, Inventory, Delivery & Lifecycle Information:

[Yazaki:](#)

[7283248430](#) [7287777010](#) [7287776910](#)