

矢崎品番	備考
7124-3835	色: ナチュラル
7124-3835-30	色: 黒

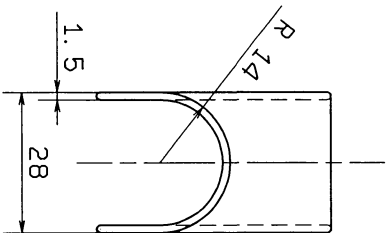
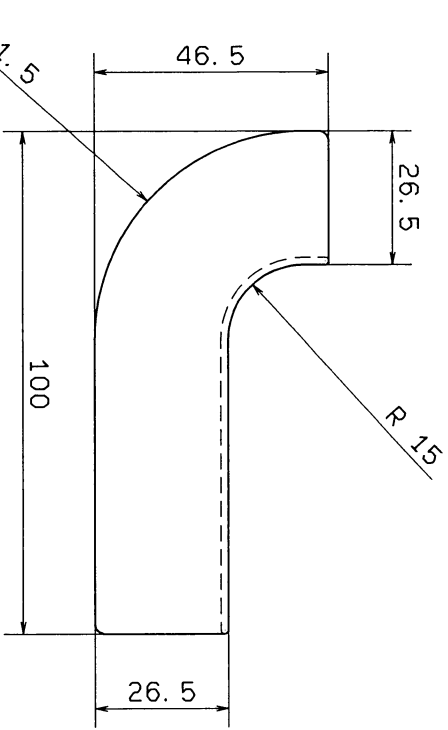
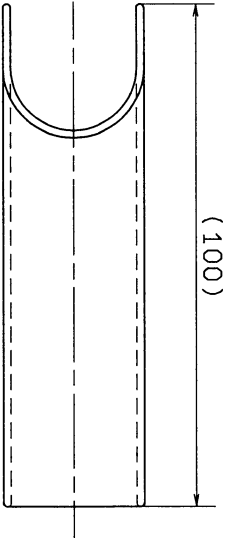

95.01.19		NEW	C95-0056	鉄(彫)	OFFICE	CUSTOMER		CUSTOMER PART NO.		CUSTOMER DWG NO.		MATL. P.P	TREAT. & FIN.	ISSUE MARK		
LET DATE		REVISION RECORD	NO.	CHKD	VENDOR	VENDOR NO.		TRIAL PART NO.		NAME		PART NO.	CH. CODE	DWG NO.		
10MAX		GENERAL TOLERANCE		ANGLE		ECCENT		DWG TYPE		DWG SOURCE		DWG DATE		UNIT	SCL	ANGLE
A	±0.15	±0.2	±0.3	±0.5	±0.75	±30'	0.1	R	NEW	95.01.19	m/m	1/1	3			
B	±0.2	±0.3	±0.55	±0.95	±1.4	±30'	0.1	APPROVED	CHECKED	CHECKED	DESIGN	DRAWN				
◎	±0.3	±0.5	±0.8	±1.4	±2	±30'	0.15	鐵羽	杯	鐵	鐵	SAITOH	鐵			
SPECIFIED		MASS		9		95.1.19		95.1.19		95.1.19		84.03.02		95.1.19		
1		2		3		YAZAKI CORPORATION		PROTECTOR		7124-3835 ETC.		7124-3835:R		YAZAKI CORPORATION		

1

2

3

1

A

B

A

B

Mouser Electronics

Authorized Distributor

Click to View Pricing, Inventory, Delivery & Lifecycle Information:

[Yazaki:](#)

[71243835](#)