

PART NO. AND CH. CODE	W <sub>1</sub> ±0.4	W <sub>2</sub> ±0.4	H <sub>1</sub>	H <sub>2</sub>	X	WIRE SIZE	MATERIAL
7116-4035	2.90	5.40	Δ(2.62)	Δ(4.52)	0.40	AVS 0.3~AVS 0.5 EQUIVALENT	C2600 (t=0.40) TIN PLATING
7116-4036	3.60	5.70	Δ(3.34)	Δ(4.38)	0.60	AVS 0.5~AVS 1.25 EQUIVALENT	C2600 (t=0.40) TIN PLATING
7116-4037	4.90	6.90	Δ(4.63)	Δ(5.42)	0.80	AVS 2~AVS 3 EQUIVALENT	COOPER ALLOY (t=0.40) TIN PLATING

- 注記  
 1. 対応相手品番：7114-4035 ETC.  
 2. 適用寸法品番：7158-3014-90 ETC.

NOTES

1. MATING PART NO. : 7114-4035 ETC.  
 2. APPLICABLE RUBBER STOPPER NO. :  
 7158-3014-90 ETC.

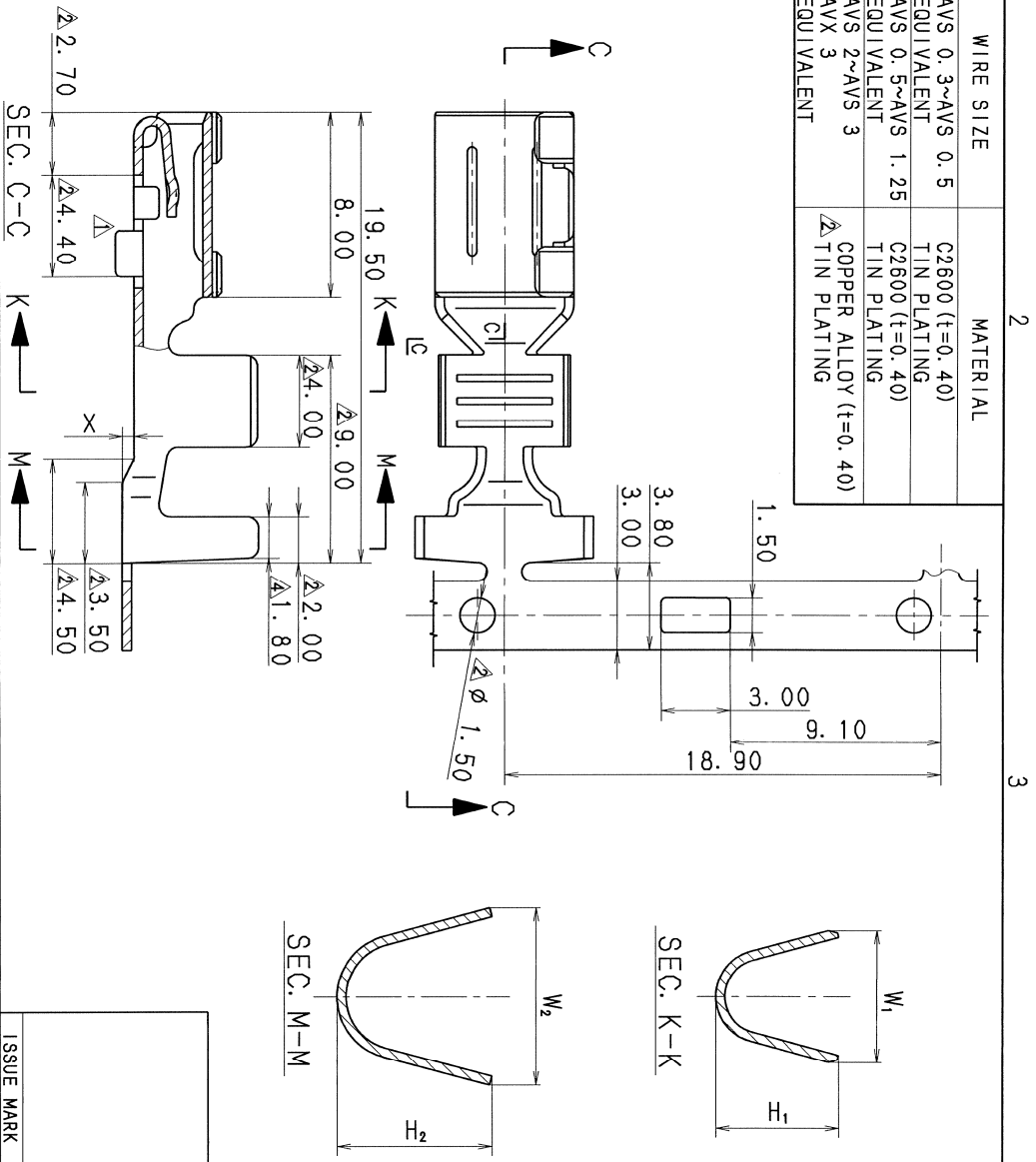
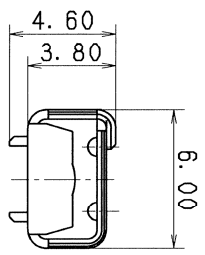

DATE	REVISION RECORD	NO.	CHKD	CUSTOMER PART NO.	CUSTOMER DWG NO.	MATL. SPEC.	SEE TABLE	TREAT. & FIN.	ISSUE MARK
2017/03/30	CORRECTION OF CLERICAL ERROR	C17-Z126	A. Q						
2007/04/19	CHANGED APPLICABLE WIRE SIZE, ETC.	C07-Z331	T. H						
1998/07/18	CHANGED DIMENSION, MATERIAL & ADDED NOTE	C97-N462	H. K						
1990/03/06	CHANGED FORM	C90-L254	K. O						
1989/10/11	NEW	C89-M089	H. Y						
GENERAL TOLERANCE									
10MAX	50MAX	100MAX	250MAX	250OVR	ANGLE	ECCENT			
±0.15	±0.2	±0.3	±0.5	±0.75	±30°	±0.1			
±0.2	±0.3	±0.55	±0.95	±1.4	±30°	0.1			
±0.3	±0.5	±0.8	±1.4	±2	±30°	0.15			
SPECIFIED							MASS		
							9		
GENERAL TOLERANCE				DWG TYPE	DWG SOURCE	DWG DATE	UNIT	SCL	ANGLE
				R	NEW	1989/10/24	mm	Δ5:1	3
				APPROVED	CHECKED	CHECKED	DESIGN	DRAWN	
				S. SUZUKI	S. ONODA		SUEYOSHI	A. QUIROL	
				2017/03/30	2017/03/30				
				YAZAKI CORPORATION					
				NAME Δ4.8 SEALED TERMINAL FEMALE					
				PART NO. 7116-4035 ETC.					
				CH. CODE 7116-4035:R					
				SET DWG NO.					

1 2 3

# Mouser Electronics

Authorized Distributor

Click to View Pricing, Inventory, Delivery & Lifecycle Information:

[Yazaki:](#)

[71164035](#) [71164037](#) [71164036](#)