

SYMBOL DEFINITION		
A DIMENSION WITHOUT AN INSPECTION REPORT SYMBOL DOES NOT REQUIRE INSPECTION. IT MAY BE CONTROLLED ON THE INDIVIDUAL COMPONENT DRAWING.	TOTAL NO OF INSPECTIONS REQUIRED	18
	LAST NO. USED	14

MISSING SYMBOLS		NO MISSING SYMBOL NUMBER			
DATE	STG	REV	M/P	CHG	ZONE
18AP02	R	A1	-	-	REDRAWN TO PD
25FE03	R	A2	-	-	UPDATED PDM ATTRIBUTES

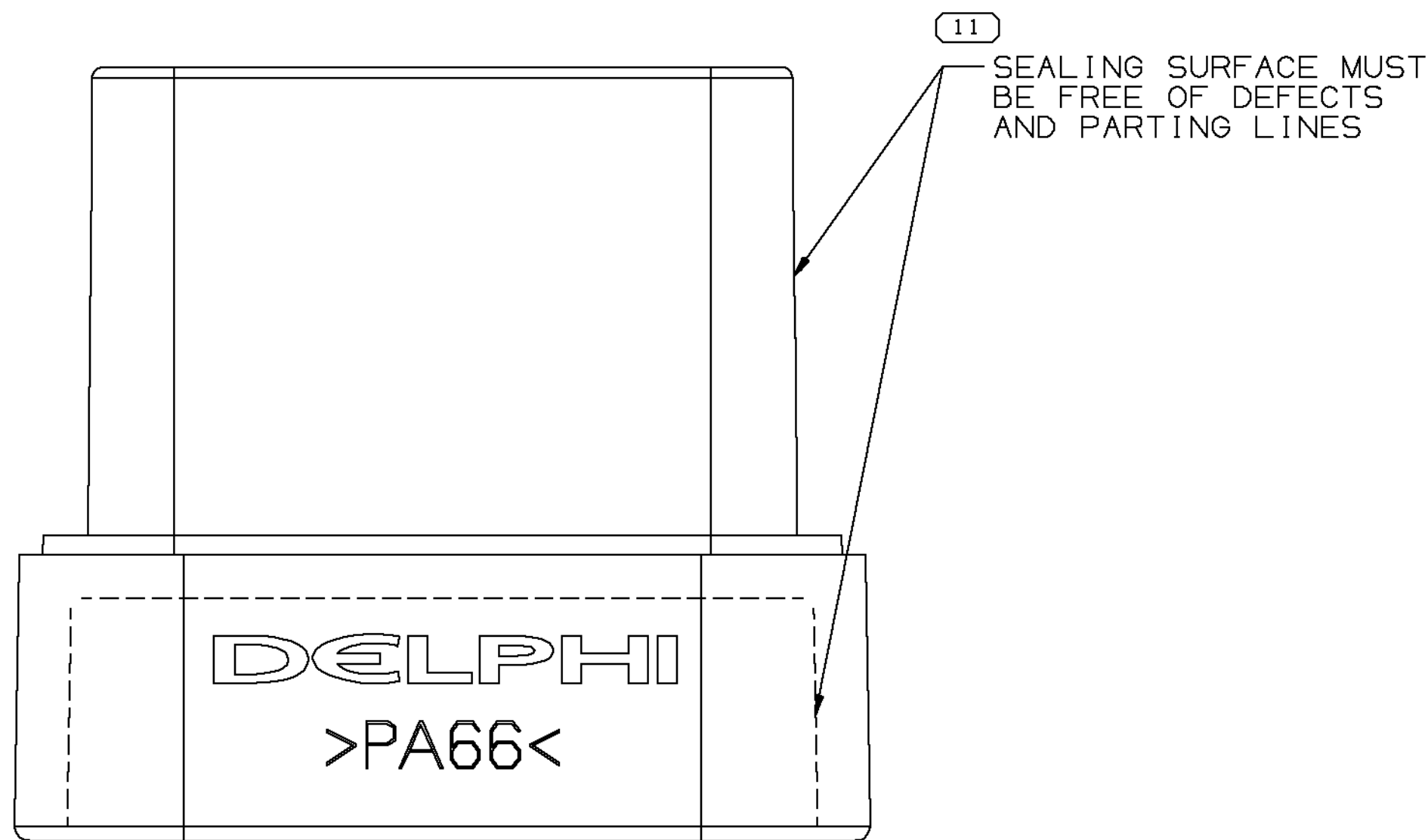
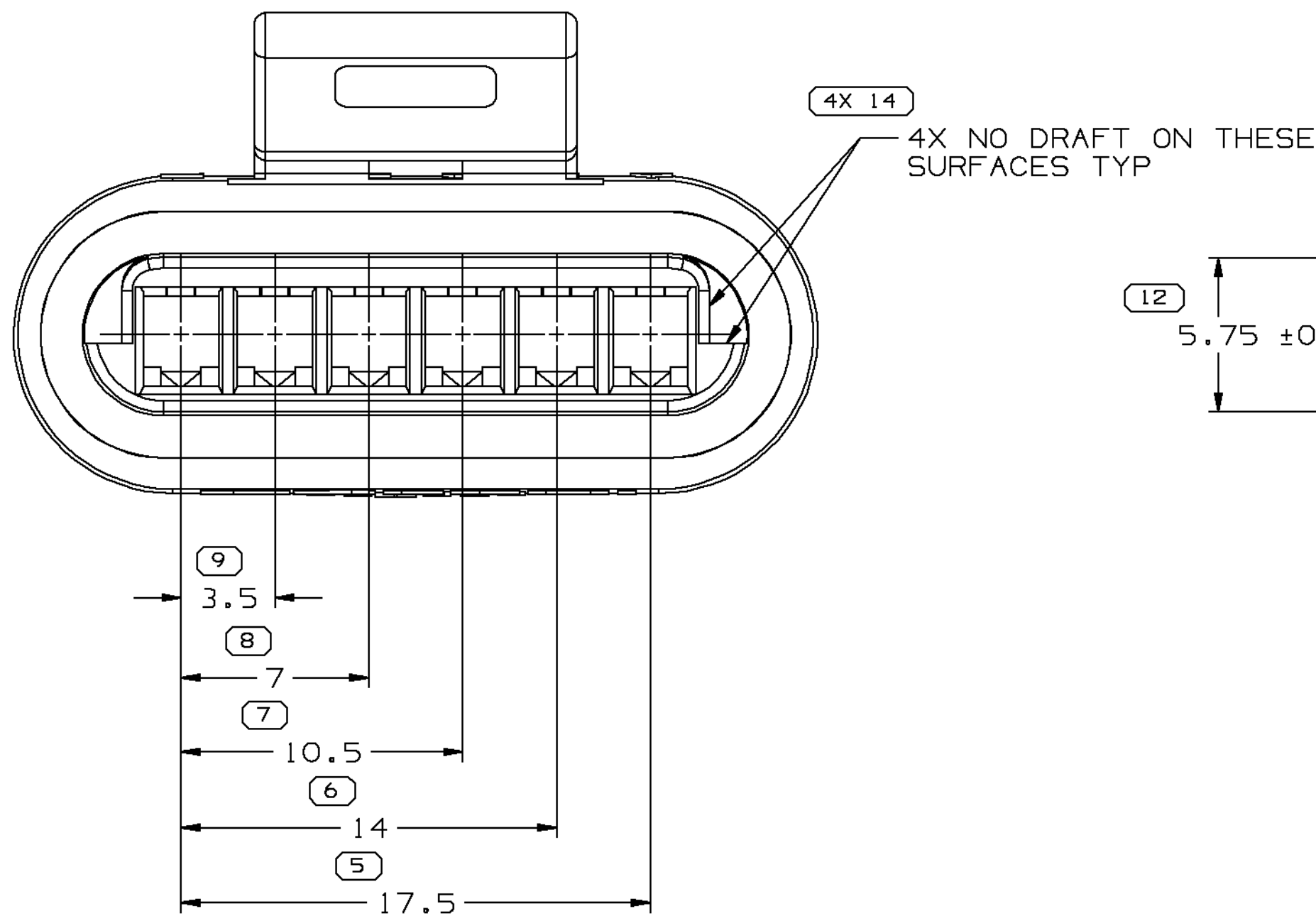
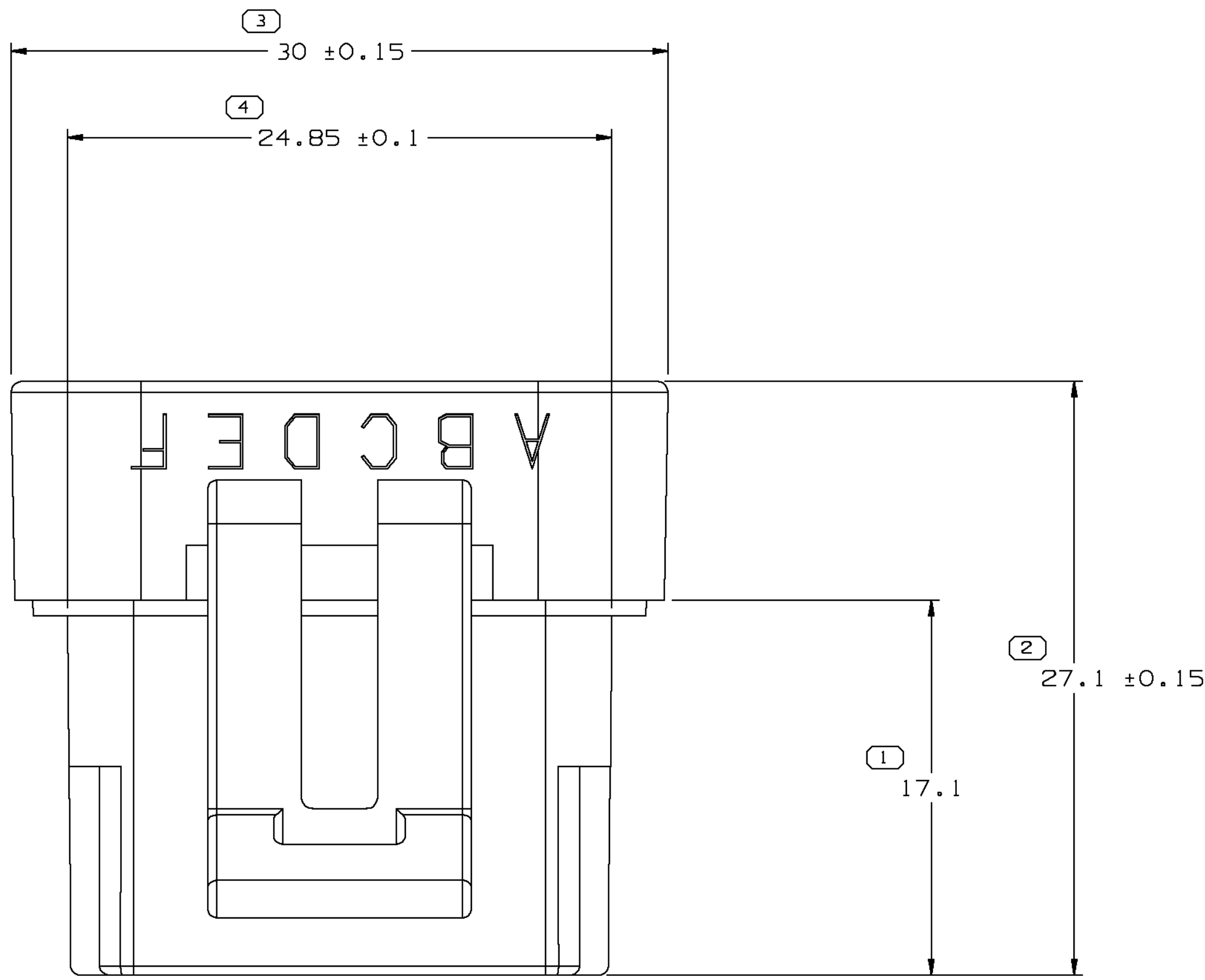

NOTES

- UNLESS OTHERWISE SPECIFIED AND/OR INDICATED: DIMENSIONS ARE TO FACE OF VIEW SHOWN AND AUTOMATICALLY ROUNDED BY COMPUTER FOR INSPECTION (SEE MATH MODEL FOR PRECISE DIMENSIONS). FOR ALL OTHER DIMENSIONS NOT SHOWN BUT REQUIRED FOR TOOL BUILD, SEE MATH MODEL FOR PRECISE TOOL PATH DATA.
- MATERIAL RECYCLING CODE >PA66< PER SAE J1344. (2.3)X(0.1) RAISED CHARACTERS AS SHOWN TO BE LOCATED ON ANY EXTERIOR SURFACE. OPTIONAL CONSTRUCTION TO BE NO MATERIAL RECYCLING CODE.
- THIS PART IS CONTROLLED FOR AUTOMATIC FEEDING AS DENOTED ON DRAWING WITH ▲.
- MATING COMPONENTS OR EQUIVALENT: CONNECTOR AND GASKET ASM. 12064915
- THIS PART ACCEPTS THE FOLLOWING COMPONENTS OR EQUIVALENT: TERMINAL 12047680
MAX INSULATION CRIMP MUST BE LESS THAN 2.54 HIGH AND 2.68 WIDE.
MAX CABLE O.D. MUST BE LESS THAN 2.54
CONNECTOR SEAL 12059226
CABLE SEAL 12052929
SEE DETAIL DRAWING FOR COMPATIBLE O.D. RANGE
- (2.3)X(0.1) RAISED DELPHI CORPORATE BRAND TO BE LOCATED ON ANY EXTERIOR SURFACE, PREFERABLY VISIBLE AT FINAL ASSEMBLY. OPTIONAL CONSTRUCTION TO BE "PED" OR NO LOGO.
- REINSHAGEN P/N AK-7095.
- THIS COMPONENT IS TOOLED AT REINSHAGEN. PHYSICAL CHANGES TO THIS PART MUST BE APPROVED BY REINSHAGEN COMPONENT ENGINEERING.

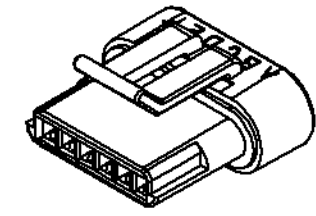

PROCESS SENSITIVE DIMENSION		THIRD ANGLE PROJECTION		DO NOT SCALE	
DIMENSIONS ENCLOSED IN () INDICATE REFERENCE DIMENSIONS AND NO TOLERANCE LIMITS ARE ESTABLISHED		USE MATH DATA		UNIGRAPHICS	
DIMENSIONAL RANGE (MM)		CHART		E1	
FROM TO		TOLERANCE UNLESS OTHERWISE SPECIFIED		ANGULAR TOLERANCE 12°	
10.15 10.2 10.3 10.4 10.5 10.6 10.8 11 11.2		0.2 0.3 0.4 0.5 0.6 0.8 1 1.2		0.1 0.2 0.3 0.4 0.5 0.6 0.8 1 1.2	

DWS TYPE		PART DRAWING	
STYLE		DATE	
VOLUME (C/P)		DISTR CODE	
ROUTING		D	
UNLESS OTHERWISE SPECIFIED		THIS DOCUMENT IS IN ACCORDANCE WITH ASME Y14.5M-1994 AS AMENDED BY THE 2003 DIMENSIONING AND TOLERANCING ADDENDUM 1997. ALL GEOMETRIC TOLERANCES AND RELATED DATUMS APPLY TO THE PART. IF PERFECT FORM AT MPC DOES NOT APPLY WHEN RELATIONSHIP BETWEEN FEATURES IS ESTABLISHED BY ORIENTATION OR LOCATION TOLERANCES, SEPARATE POSITION CALLOUTS MAY BE BASED SEPARATELY. ALL DIMENSIONS ARE IN MILLIMETERS	
REFERENCE		12040944	
THIRD ANGLE PROJECTION		DO NOT SCALE	
USE MATH DATA		UNIGRAPHICS	

DELPHI	
DELPHI PACKARD ELECTRIC SYSTEMS WARREN, OH	
OR	
APVD1 R. HERMOSILLO	18AP02
APVD2 R. HERMOSILLO	18AP02
APVD3 G. MACIAS	18AP02
APVD4	
APVD5	
SUBSTANCES OF CONCERN AND RECYCLED CONTENT PER DELPHI 10949001	
MATERIAL W3592001 PA66 HS 1M BLK	
DRAWING NAME CONN 6F M/P 150 P2S	
DRAWING NUMBER 12066316	
SIZE A0	SCALE 5:1
FRAME NO 1	SHEET NO 1 OF 1
STG R	REV A2
M	

Mouser Electronics

Authorized Distributor

Click to View Pricing, Inventory, Delivery & Lifecycle Information:

[Aptiv:](#)
[12066316](#)