

DWG STATUS				ZONE		REVISION HISTORY		AUTH	DR	APPV	APPD
DATE	REV	BY	CHK	REV	NO	DESCRIPTION	DATE	BY	APPV	APPD	DATE
31JUL03	R	BA	-	-	-	CLEARED REV COL. ADDED DIM 33.50 ± 0.3 & REMOVED DIM 2.0	244119	RAD	BA	EM	

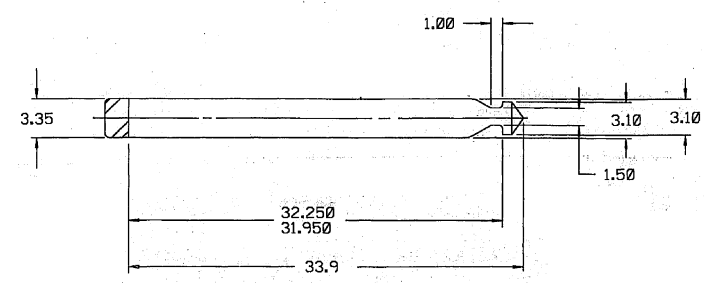
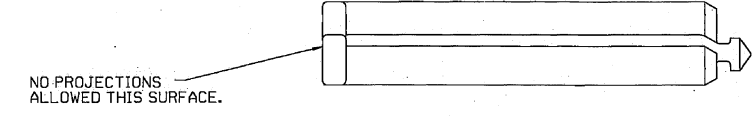
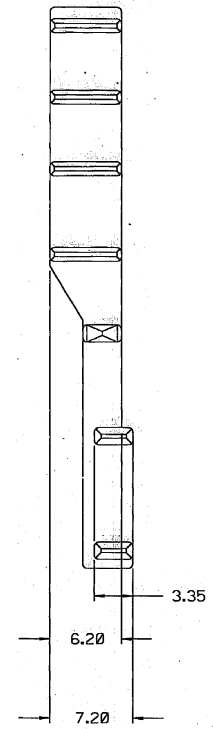
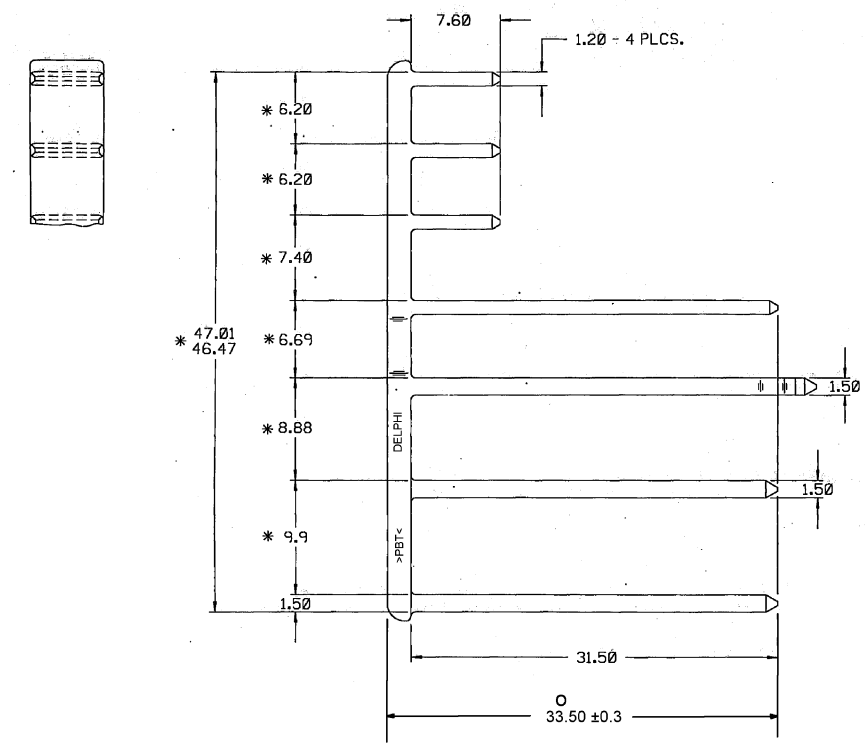

- NOTES
- ALL RADII 0.40 UNLESS OTHERWISE SPECIFIED
 - * DIMENSIONS TO BE MEASURED AT BASE OF PART WITH BASE HELD IN FLAT, STRAIGHT POSITION.
 - THIS PART MATES TO 12064832 OR EQUIVALENT.
 - THIS PART IS NOT CONTROLLED FOR AUTOMATIC FEEDING.
 - (2.3) X (0.1) RAISED DELPHI CORPORATE BRAND TO BE LOCATED ON ANY EXTERIOR SURFACE, PREFERABLY VISIBLE AT FINAL ASSEMBLY. OPTIONAL CONSTRUCTION TO BE "PED" OR NO LOGO
 - MATERIAL RECYCLING CODE >PBT< PER SAE J1344. (2.3) X (0.1) RAISED CHARACTERS AS SHOWN TO BE LOCATED ON ANY EXTERIOR SURFACE. OPTIONAL CONSTRUCTION TO BE NO MATERIAL RECYCLING CODE.

PART DRAWING	
STYLE	
VOLUME (CM)	DISTR CODE
ROUTING	6900
UNLESS OTHERWISE SPECIFIED: THIS DRAWING IS VALID ONLY WHEN USED IN CONJUNCTION WITH THE ORIGINAL DRAWING AND TECHNICAL ASSISTANCE. IT IS NOT TO BE USED FOR CONSTRUCTION OF PARTS OR FOR REPAIRS. IT IS NOT TO BE USED FOR REVISIONS. IT IS NOT TO BE USED FOR REVISIONS. IT IS NOT TO BE USED FOR REVISIONS.	
REFERENCE	
THIRD ANGLE PROJECTION	

DELPHI
DELPHI PACKARD ELECTRIC SYSTEMS
WARREN, OH

THE DRAWING IS THE PROPERTY OF DELPHI CORPORATION. RIGHTS ARE RESERVED TO THE DRAWING OR PARTS THEREOF. THIS IS A COPY OF THE ORIGINAL DRAWING.

DR	DATE
APPROV: A. ALVIDREZ	290C02
APPROV: A. ALVIDREZ	290C02
APPROV: E. TRACEY	310C02
APPROV:	

SUBSTANCE(S) OF CONCERN AND RECYCLED CONTENT PER DELPHI 1004001

MATERIAL: M4655001 PBT NAT

DRAWING NAME: SECONDARY LOCK COMB

DRAWING NUMBER: **12064835**

SIZE: AD NONE 1 OF 1 1 OF 1 R B4

Mouser Electronics

Authorized Distributor

Click to View Pricing, Inventory, Delivery & Lifecycle Information:

[Aptiv:](#)

[12064835](#)