

DWG STATUS				ZONE		REVISION HISTORY		AUTH		DR		APPROV	
DATE	STG	REV	REP	CHG						HH	ARA	EM	EM
06AUG03	R	B4	-	-			3.1 +0.15/-0.25 VMS 3.1 (2 PLCS)		244211				
							REMOVED DIMS (2 PLCS) & ADDED 35.1 +/-0.3 & 37.1 +/-0.3		244245				

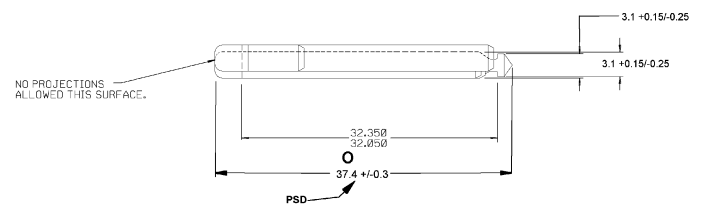
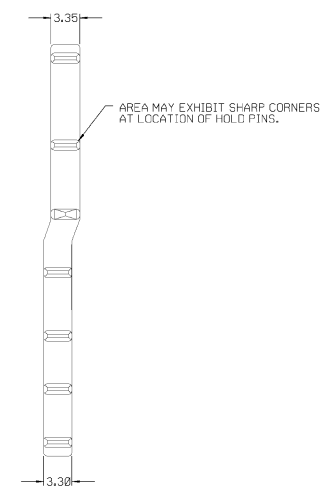
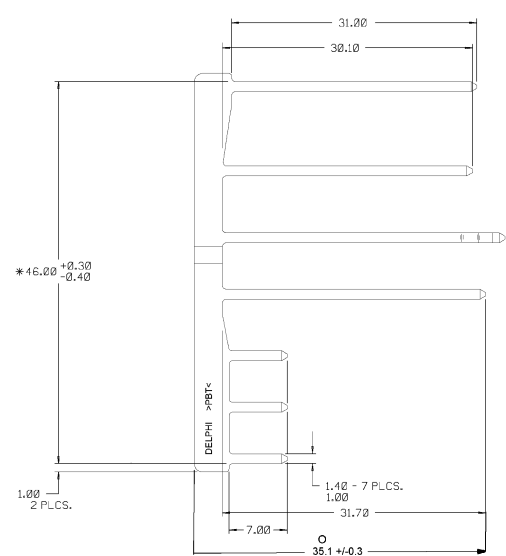

NOTES

- * DIMENSIONS TO BE MEASURED AT BASE OF PART WITH BASE HELD IN FLAT, STRAIGHT POSITION.
- THIS PART MATES TO 12064831 OR EQUIVALENT.
- THIS PART IS NOT CONTROLLED FOR AUTOMATIC FEEDING.
- FOR POLYESTER IN-PROCESS MOISTURE AND PART DEGRADATION LIMITS SEE ESO-1502 CLASS I.
- (2.3) X (0.1) RAISED DELPHI CORPORATE BRAND TO BE LOCATED ON ANY EXTERIOR SURFACE, PREFERABLY VISIBLE AT FINAL ASSEMBLY. OPTIONAL CONSTRUCTION TO BE "PED" OR NO LOGO.
- MATERIAL RECYCLING CODE >PBT< PER SAE J1344. (2.3) X (0.1) RAISED CHARACTERS AS SHOWN TO BE LOCATED ON ANY EXTERIOR SURFACE. OPTIONAL CONSTRUCTION TO BE NO MATERIAL RECYCLING CODE.

PART DRAWING			
STYLE		DISTR CODE	D
VOLUME (CM)			
ROUTING	6900		
UNLESS OTHERWISE SPECIFIED: THIS DRAWING IS TO BE CONSIDERED AS THE FINAL DESIGN. ANY CHANGES TO THIS DRAWING MUST BE APPROVED BY THE ORIGINAL ENGINEER AND THE ORIGINAL APPROVER. THIS IS A WORKING DRAWING AND IS NOT TO BE USED FOR PRODUCTION PURPOSES WITHOUT THE WRITTEN PERMISSION OF THE ORIGINAL ENGINEER. ANY UNAUTHORIZED REVISIONS WILL BE CONSIDERED AS A VIOLATION OF COMPANY POLICY.			
REFERENCE	COMB M/P 150,280,480,630		
THIRD ANGLE PROJECTION			

DELPHI
DELPHI PACKARD ELECTRIC SYSTEMS
WARREN, OH

DR	R AVILA	DATE	090C02
APPROV	R HERMOSILLO		090C02
APPROV	E TRACEY		100C02
APPROV			
SUBSTANCES OF CONCERN AND RECYCLED CONTENT PER DELPHI 1504001			
MATERIAL	M4695008 PBT BLU		
DRAWING NAME	COMB M/P 150,280,480,630		
DRAWING NUMBER	12064834		
SIZE	AD	SCALE	NONE
FRAME NO	1	SHEET NO	1 OF 1
STG	R	REV	B4

Mouser Electronics

Authorized Distributor

Click to View Pricing, Inventory, Delivery & Lifecycle Information:

[Aptiv:](#)
[12064834](#)