

SYMBOL DEFINITION		MISSING SYMBOLS	
A DIMENSION WITHOUT AN INSPECTION REPORT SYMBOL (I) DOES NOT REQUIRE INSPECTION. IT MAY BE CONTROLLED ON THE INDIVIDUAL COMPONENT DRAWING.	TOTAL NO. OF INSPECTIONS REQUIRED	NO MISSING SYMBOL NUMBER	
	50		
	LAST NO. USED		
	23		

REV. NO.	DATE	BY	CHKD.	REVISION HISTORY	AUTH.	SH.	APP'D.
33305408	R 01	-	-	WAS RELEASED, REVISED AND RE-RELEASED	431580	JM	JM/001
112016	R 02	-	-	ALL PARTS - CPA WAS 33305377, DIM #21 WAS 2X (11,92) DIM #22 WAS 10X(26,1) & DIM #43 WAS 4X (1,2)	433914	DO	DO/004
230417	R 03	-	-	ALL PARTS - REVISION DIM WAS 02 FOR AUTH NUMBER 433914	436704	XV	XV/01
050217	R 04	-	-	ALL PARTS - REVISED GRAPHICS	437657	NS	NS/05
140217	R 05	-	-	ALL PARTS - REVISED GRAPHICS	438751	NS	NS/05
020218	R 06	-	-	ALL PARTS - PROCESS SENSITIVE DIMENSION WAS #23 AND ADDED "OP" POSITION NOTE	439114	SM	SM/01
250918	R 07	-	-	ALL PARTS - UPDATED PART AVAILABILITY	439176	SM	SM/01
020418	R 08	-	-	ALL PARTS - REVISED NOTE #43	440566	NS	NS/05

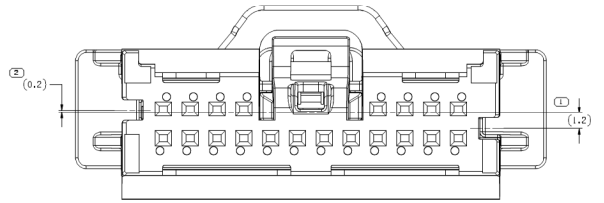

TYPE 102  
SAME AS TYPE 101  
EXCEPT AS SHOWN

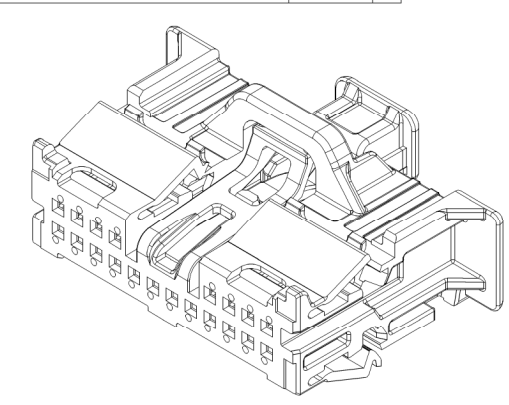
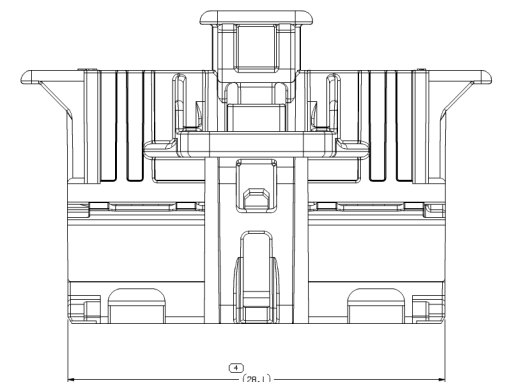
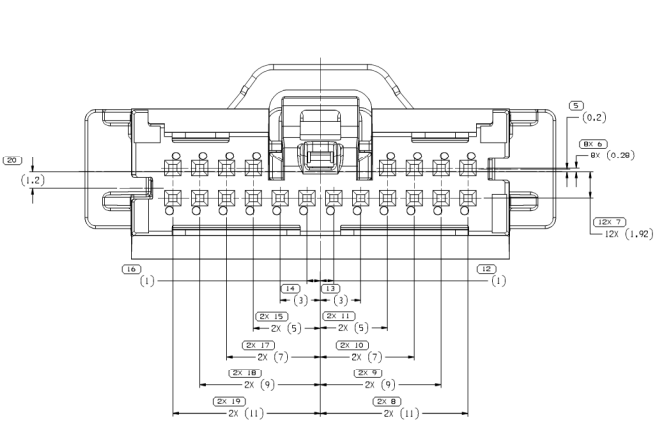

TYPE 101

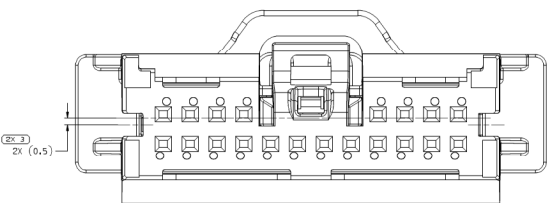
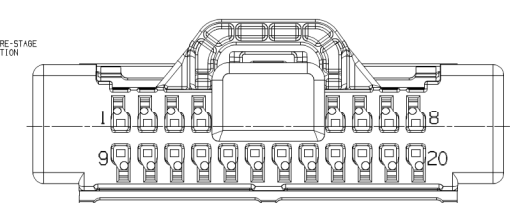
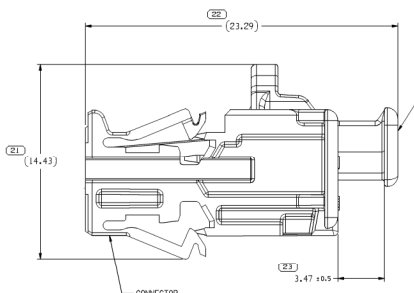

TYPE 103  
SAME AS TYPE 101  
EXCEPT AS SHOWN

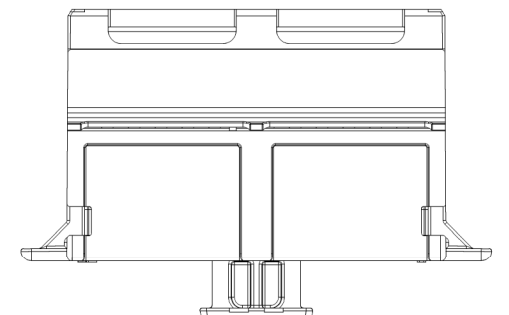

- NOTES
- UNLESS OTHERWISE SPECIFIED AND/OR INDICATED: DIMENSIONS ARE TO FACE OF VIEW SHOWN AND AUTOMATICALLY ROUNDED BY COMPUTER FOR INSPECTION (SEE WITH MODEL FOR PRECISE DIMENSIONS); FOR ALL OTHER DIMENSIONS NOT SHOWN BUT REQUIRED FOR TOOL BUILD, SEE WITH MODEL FOR PRECISE TOOL PATH DATA.
  - WHEN PARTS ARE SHIPPED THEY MUST BE PUSHED IN PLASTIC BAGS OR SHIPPING CONTAINERS MUST BE LINED WITH PLASTIC LINERS. BAGS OR LINERS MUST BE SEALED TO AVOID FOREIGN MATTER.
  - SEALING CODE 1 - DESIGN WILL MEET REQUIREMENTS OF SAE/J1455-6 UNSEALED CONNECTOR SYSTEM ENVIRONMENTAL TEST FLOWCHART
  - THIS PART IS NOT CONTROLLED FOR AUTOMATIC FEEDING.
  - FOR APPLICATION DATA SEE THE INDIVIDUAL APPLICATION DRAWINGS.

33305408

REV.	NO.	REV. NO.	TYPE	CPA	CPA
33305411	04	AC	103	33305407	33380638
33305410	04	AC	102	33305406	33380638
33305409	04	AC	101	33305405	33380638

REV.	NO.	REV. NO.	TYPE	CPA	CPA
33305411	04	AC	103	33305407	33380638
33305410	04	AC	102	33305406	33380638
33305409	04	AC	101	33305405	33380638

**DELPHI**  
DELPHI FINLAND ELECTRICAL/ELECTRONIC ARCHITECTURE

THIS DRAWING IS THE PROPERTY OF DELPHI. IT IS LOANED TO YOU FOR YOUR INFORMATION ONLY. IT IS NOT TO BE REPRODUCED OR TRANSMITTED IN ANY FORM OR BY ANY MEANS, ELECTRONIC OR MECHANICAL, INCLUDING PHOTOCOPYING, RECORDING, OR BY ANY INFORMATION STORAGE AND RETRIEVAL SYSTEM, WITHOUT THE EXPRESS WRITTEN PERMISSION OF DELPHI.

DATE: PART DRAWING

DESIGNED BY	J. GARRETSOHN	DRAWN BY	J. GARRETSOHN
CHECKED BY	J. GARRETSOHN	DATE	02.02.15
APPROVED BY	J. GARRETSOHN	DATE	02.02.15

UNLESS OTHERWISE SPECIFIED: DIMENSIONS ARE IN MILLIMETERS

ALL DIMENSIONS ARE IN MILLIMETERS

THIRD ANGLE PROJECTION

SCALE: 1:1

DATE: 02.02.15

33305408

12 OF 21

33302408

# Mouser Electronics

Authorized Distributor

Click to View Pricing, Inventory, Delivery & Lifecycle Information:

[Aptiv:](#)

[33305410](#)